

STATE OF MARYLAND

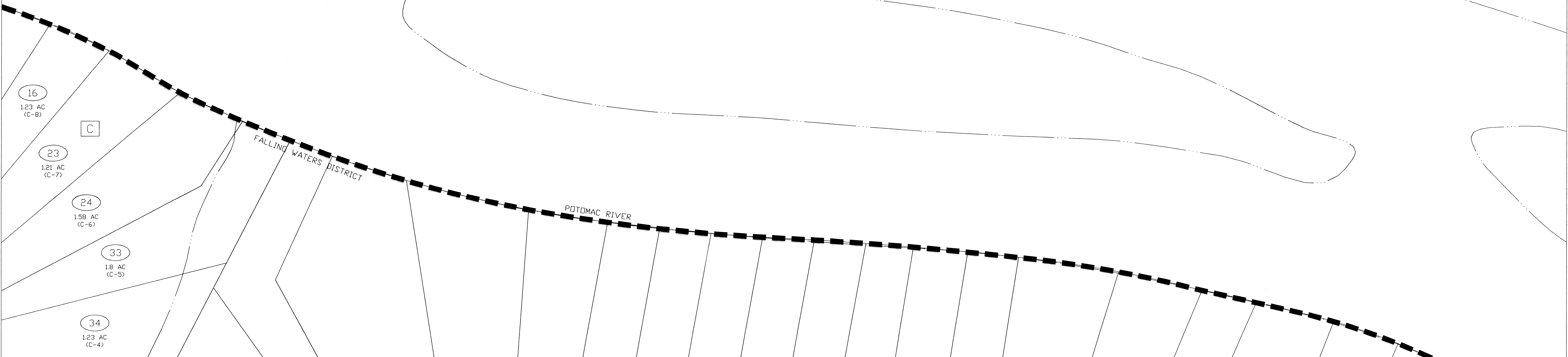

For Tax Purposes Only  
 Prepared by  
**SMART DATA STRATEGIES**  
 sds-inc.com  
 FRANKLIN, TN

LEGEND	
Property line	—————
ROW	—————
Water property	—————
Railroad ROW	—————
Original lot line	- - - - -
Road easement	- - - - -
Corporation line	—————
District line	—————
County line	—————
State line	—————
Parcel or index number in circle	(26)
Deed lot number (in parenthesis)	(15)

REVISIONS	
1	CURRENT TO JULY 1, 2002
2	CURRENT TO JULY 1, 2003
3	CURRENT TO JULY 1, 2004
4	CURRENT TO JULY 1, 2005
5	
6	
7	
8	
9	
10	
11	
12	
13	
14	
15	
16	

RESTRICTION

All tax maps created under the provisions of reappraisal legislation are the property of the Berkeley County and the reproduction, copying, distribution or sale of such tax maps or any copies thereof without the written permission of the Berkeley County Assessor is prohibited by law.

KEY MAP		
FW2	FW2	FW2
FW2A	FW2B	FW2
FW2C	FW2D	FW2E

COUNTY OF BERKELEY  
 WEST VIRGINIA  
 Office of Assessor

<b>FW2B</b>	
Date, Aerial Photography: Photo No:	Date, Map: Scale: 1" = 100'