

11-J 12-J
11-K 12-K

12-J 13-J
12-K 13-K

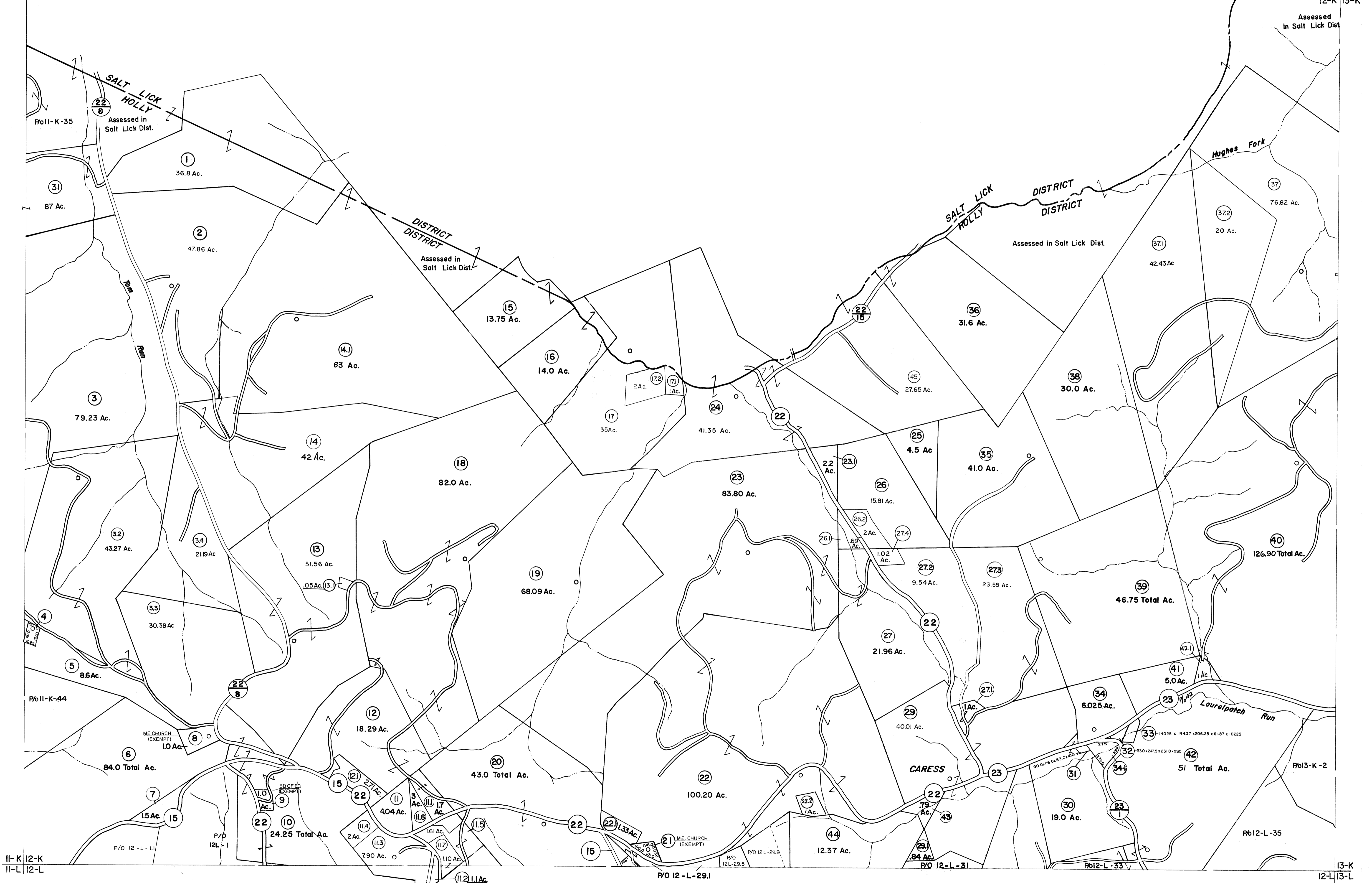

11-K 12-K
11-L 12-L

13-K
12-L 13-L

For Tax Purposes Only

Prepared by
VOGT, IVERS AND ASSOCIATES
 ENGINEERS-ARCHITECTS
 CHARLESTON, W.VA.
 CINCINNATI, OHIO

Property line	---	Original lot line	---
Edge of pavement or roadway	---	Deed lot number	(13)
Corporation line	---	Parcel or index number	(15)
District line	---	Improvement	o
County line	---	Railroad	o

Revisions			
1	3-7-76	DS	9
2	Revised to 7-80		10
3	" " 7-1-83		11
4	7-1-84	L.E.S.	12
5	Revised to 7-1-85		13
6	July, 1987	TRM	14
7	REV. TO 1-1-88	R.E.B.	15
8			16
9	OGIS	5/4/95	SAJ
10	O.G.I.S	6-1-96	J.E.B
11		5-1-97	J.E.B
12		4-15-98	J.E.B
13		5-1-99	J.E.B
14		5/4/2003	S.B.H
15		4/19/04	S.B.H
16		4/26/05	S.B.H
17		4/9/06	S.B.H
18		4/14/07	S.B.H
19		4/19/08	S.B.H
20		4-8-11	H 45
21		6-9-12	S.B.H
22		2/18/15	S.B.H
23		2/8/17	S.L.S
24			

KEY MAP

11-J	12-J	13-J
11-K	12-K	13-K
11-L	12-L	13-L

BRAXTON COUNTY
 STATE OF WEST VIRGINIA
 Office of Assessor

DISTRICT	HOLLY DISTRICT
SHEET NO:	12-K
Date, Aerial Photography:	4-20-60
Photo No:	BR-14-57
Date, Map:	9-20-62
Scale:	1" = 400'