

13-J 14-J  
13-K 14-K

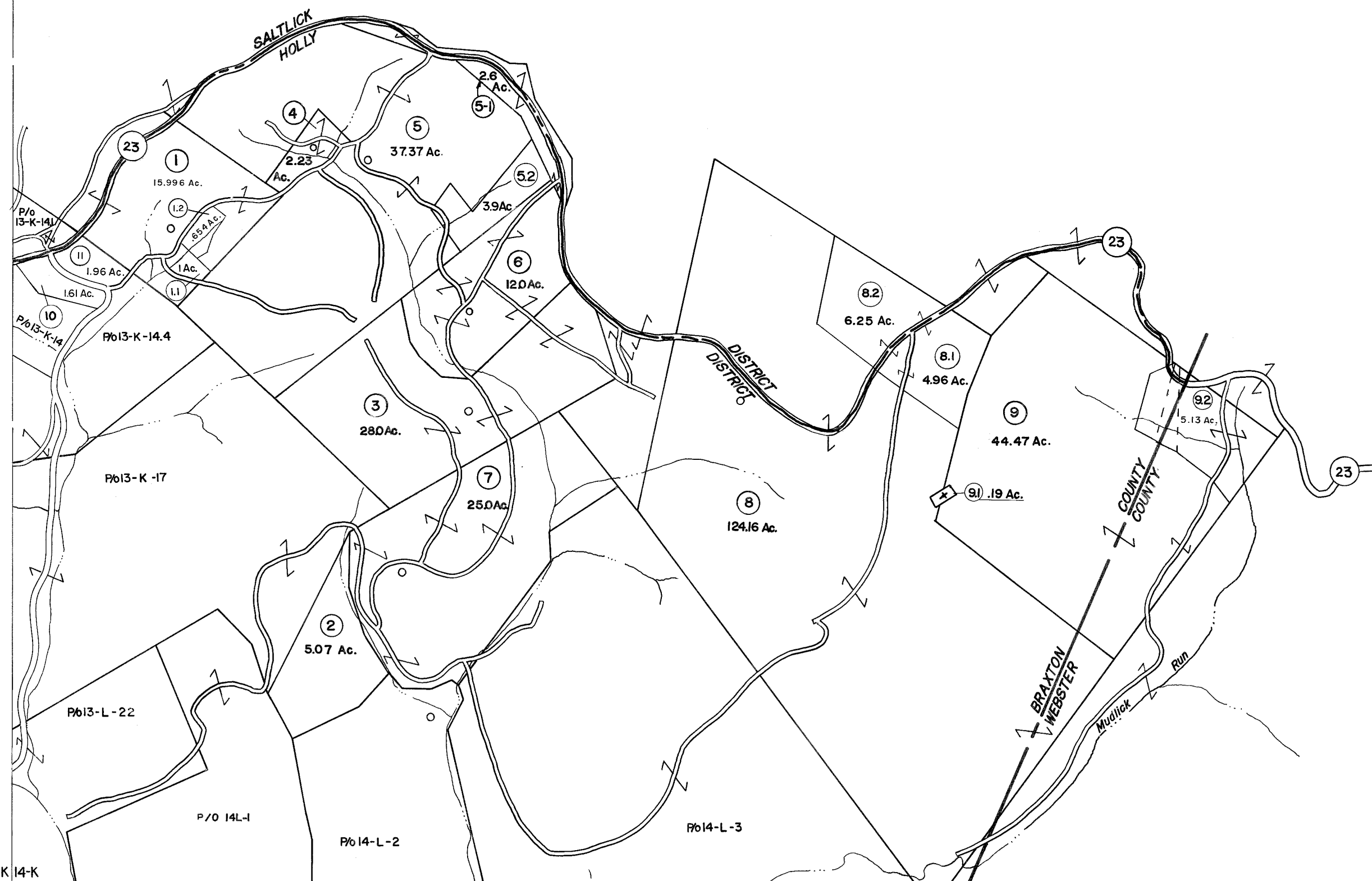

13-K 14-K  
13-L 14-L



For Tax Purposes Only

Prepared by  
**VOGT, IVERS AND ASSOCIATES**  
ENGINEERS-ARCHITECTS  
CHARLESTON, W.VA.  
CINCINNATI, OHIO

Property line  
Edge of pavement or roadway  
Corporation line  
District line  
County line

Original lot line  
Deed lot number  
Parcel or index number  
Improvement  
Railroad

Revisions			
1	3-8-76 DS	9	ESI 5/31/01 REK 17
2	Revised to 7-80 J.E.B.	10	ESI 6/14/02 REK 18
3	" " 7-1-83 J.E.B.	11	4/30/03 S.B.H. 19
4	7-1-84 L.E.S.	12	4/26/05 S.B.H. 20
5	July, 1987 TRL	13	6-9-12 S.B.H. 21
6	OGIS 2/10/91 DSH	14	
7	EXCALIBUR GRAPHICS 5/93	15	
8	O.G.I.S. 6-1-96 J.E.B.	16	

KEY MAP

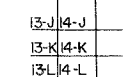

**BRAXTON COUNTY**

STATE OF WEST VIRGINIA

Office of Assessor

DISTRICT

**HOLLY DISTRICT**

SHEET NO: **14-K**

Date, Aerial Photography: 4-22-60  
Photo No: BR-14-19

Date, Map: 8-6-62  
Scale: 1" = 400'