

This area shown on map HD-3 1"=100'

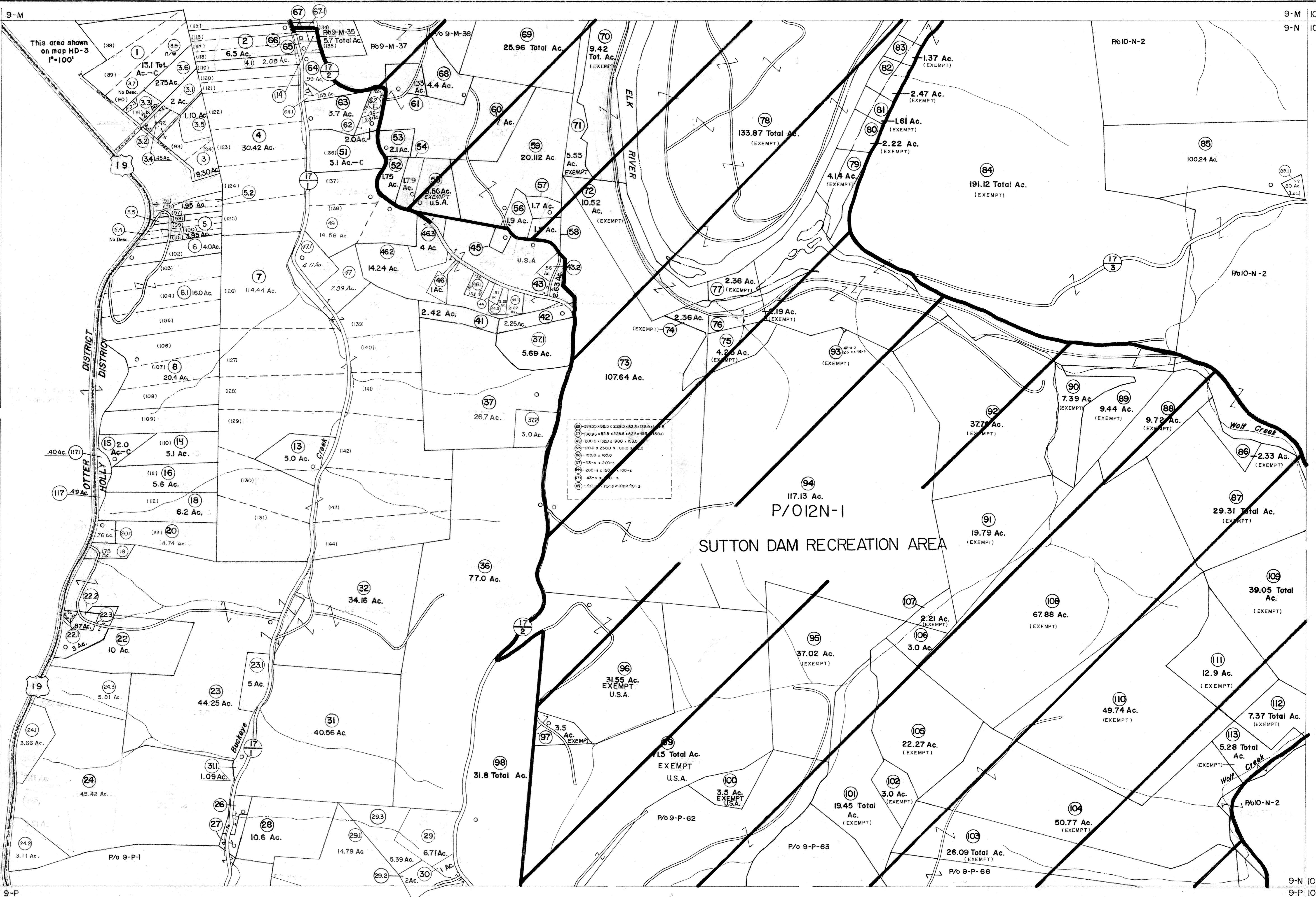

(20) - 374.55 x 82.5 x 228.5 x 82.5 x 133.91 x 125.5
 (21) - 158.65 x 82.5 x 228.5 x 82.5 x 453.15 x 60.0
 (22) - 200.0 x 150.0 x 190.0 x 153.0
 (23) - 90.0 x 238.0 x 100.0 x 100.0
 (24) - 100.0 x 100.0
 (25) - 43.5 x 200.0
 (26) - 200.0 x 150.0 x 100.0
 (27) - 45.5 x 100.0
 (28) - 90.0 x 75.0 x 100.0 x 90.0

SUTTON DAM RECREATION AREA

P/O12N-1

11.5 Total Ac. EXEMPT U.S.A.

31.8 Total Ac.

31.55 Ac. EXEMPT U.S.A.

77.0 Ac.

34.16 Ac.

40.56 Ac.

5 Ac.

44.25 Ac.

10 Ac.

5.81 Ac.

45.42 Ac.

3.66 Ac.

P/O 9-P-1

9-P

For Tax Purposes Only

Prepared by
VOGT, IVERS AND ASSOCIATES
 ENGINEERS-ARCHITECTS
 CHARLESTON, W.VA.
 CINCINNATI, OHIO

Property line	—	Original lot line	---
Edge of pavement or roadway	==	Deed lot number	(15)
Corporation line	----	Parcel or index number	(29)
District line	----	Improvement	o
County line	----	Railroad	—+—

Revisions			
1	PARCEL 29-1 ADDED 7-3-63	9	Revised to 7-1-85
2	PARCEL 67-1 ADDED 7-3-63	10	July, 1967
3	2-7-73 JACK REEVES	11	REV. TO 1-1-88
4	3-3-76	12	OGIS 2/9/91
5	Revised to 7-80	13	OGIS 5/3/95
6	Revised to 7-1-85	14	O.G.I.S 6-1-96
7	7-1-84	15	L.E.S. 5-1-97
8	Revised to 7-1-81	16	4-15-98
17	5-1-99	18	J.E.B. 5/30/01
19	REK 6/13/02	20	5/2/04
21	S&B 4/9/06	22	S&B 4/12/07
23	S&B	24	

KEY MAP

8-M 9-M 10-M
9-N 10-N
9-P 10-P

BRAXTON COUNTY

STATE OF WEST VIRGINIA

Office of Assessor

DISTRICT
HOLLY DISTRICT

SHEET NO: 9-N

Date, Aerial Photography: 4-22-60
Photo No: BR-14-122

Date, Map: 9-20-62
Scale: 1" = 400'