

For Tax Purposes Only

Prepared by
YOGT, IVERS AND ASSOCIATES
 ENGINEERS-ARCHITECTS
 CHARLESTON, W.VA.
 CINCINNATI, OHIO

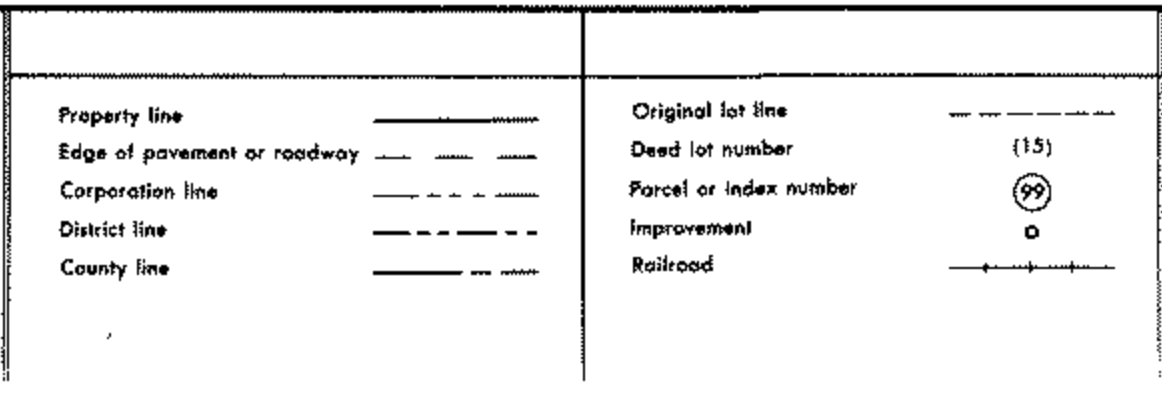

Revisions		KEY MAP	
1	PARCELS 1-1, 2-1, 16-1, 25-1, 26-1	9	ES1 5/24/01 REK
2	26-2, ADDED - 5-28-83	10	ES1 6/2/01 REK
3	P/W	11	OGIS 2/10/91 DSH
4	Revised to 7-1-84	12	EXCALIBUR GRAPHICS 5/93
5	7-1-83 OBG	13	O.G.I.S. 1-1-95 J.E.B
6	7/1/84 RLB	14	O.G.I.S. 6-1-96 J.E.B
7	Revised to 7-1-85	15	5-1-97 J.E.B
8	Revised to 7-1-86	16	ES1 4-27-00 REK
		17	ES1 5/24/01 REK
		18	ES1 6/2/01 REK
		19	5/11/03 S.B.H
		20	5/5/04 S.B.H
		21	4/9/06 S.B.H
		22	4/15/07 S.B.H
		23	4/21/08 S.B.H
		24	4/14/09 S.B.H

BRAXTON COUNTY
 STATE OF WEST VIRGINIA
 Office of Assessor

DISTRICT
OTTER DISTRICT

SHEET NO: 7-J

Date, Aerial Photography: 4-22-60 Date, Map: 8-7-62
 Photo No: BR-14-155 Scale: 1" = 400'