

5-M  
5-N

5-M  
5-N  
6-M  
6-N

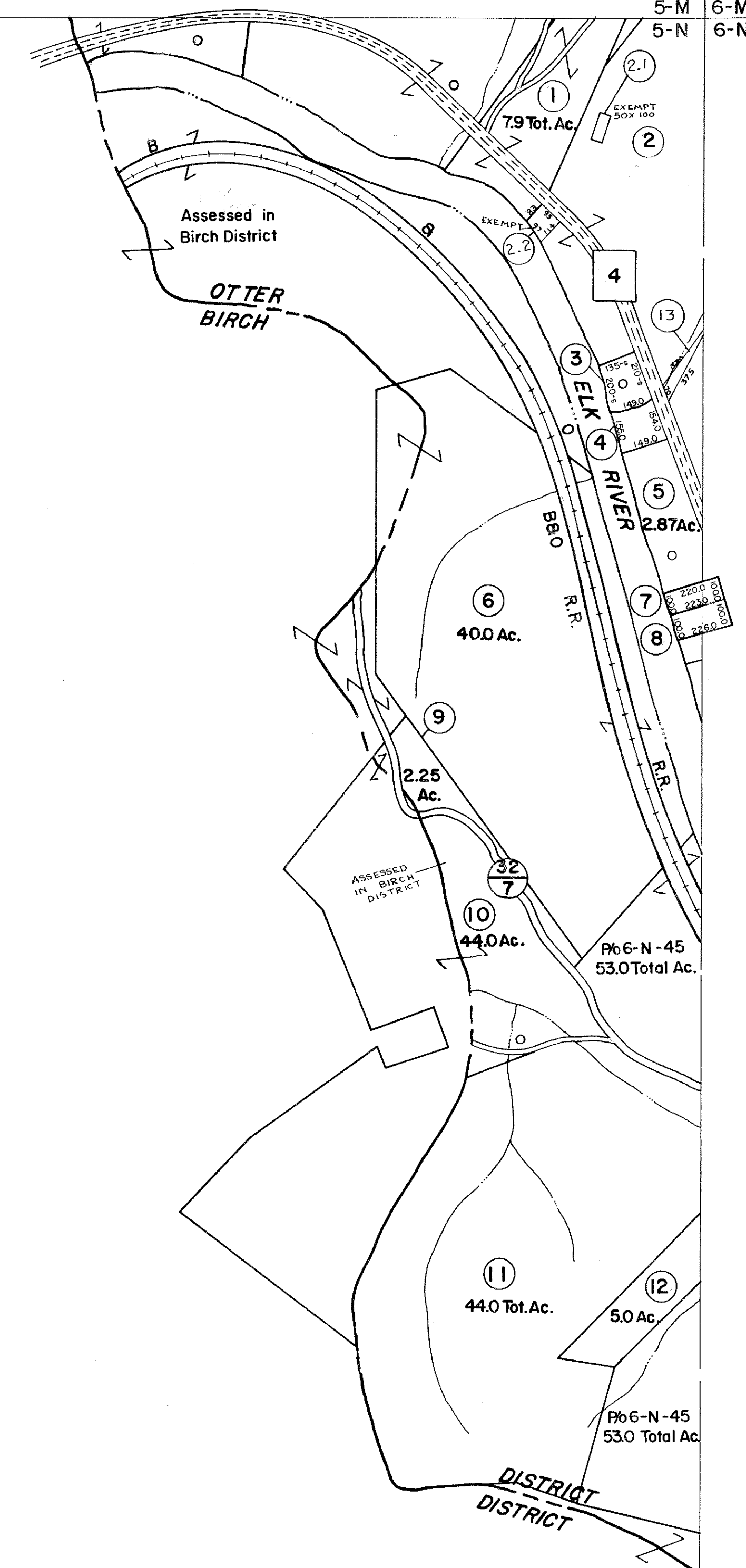

5-N

5-N  
6-N  
6-P

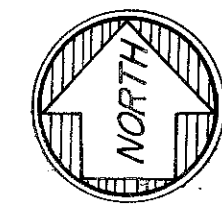

For Tax Purposes Only  
 Prepared by  
**VOGT, IVERS AND ASSOCIATES**  
 ENGINEERS-ARCHITECTS  
 CHARLESTON, W.VA.  
 CINCINNATI, OHIO

Property line \_\_\_\_\_  
 Edge of pavement or roadway - - - - -  
 Corporation line - - - - -  
 District line - - - - -  
 County line - - - - -

Original lot line - - - - -  
 Deed lot number (15)  
 Parcel or index number (9)  
 Improvement (o)  
 Railroad (—+—)

Revisions	
1	Revised to 7-1-80 RLB
2	" " 7-1-83 OCB
3	7/1/84 RLB
4	Revised to 1-1-88 RLB
5	
6	
7	
8	
9	
10	
11	
12	
13	
14	
15	
16	
17	
18	
19	
20	
21	
22	
23	
24	

KEY MAP

**BRAXTON COUNTY**  
 STATE OF WEST VIRGINIA  
 Office of Assessor

DISTRICT  
**OTTER DISTRICT**  
 SHEET NO: 5-N  
 Date, Aerial Photography: 4-22-60  
 Photo No: BR-14-190  
 Date, Map: 9-10-62  
 Scale: 1" = 400'