

10-E 11-E  
10-F 11-F

BURNSVILLE DAM WATERSHED AREA

11-E 12-E  
11-F 12-F

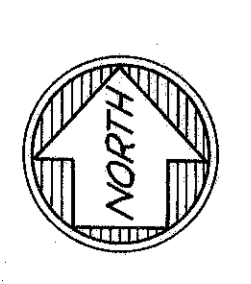
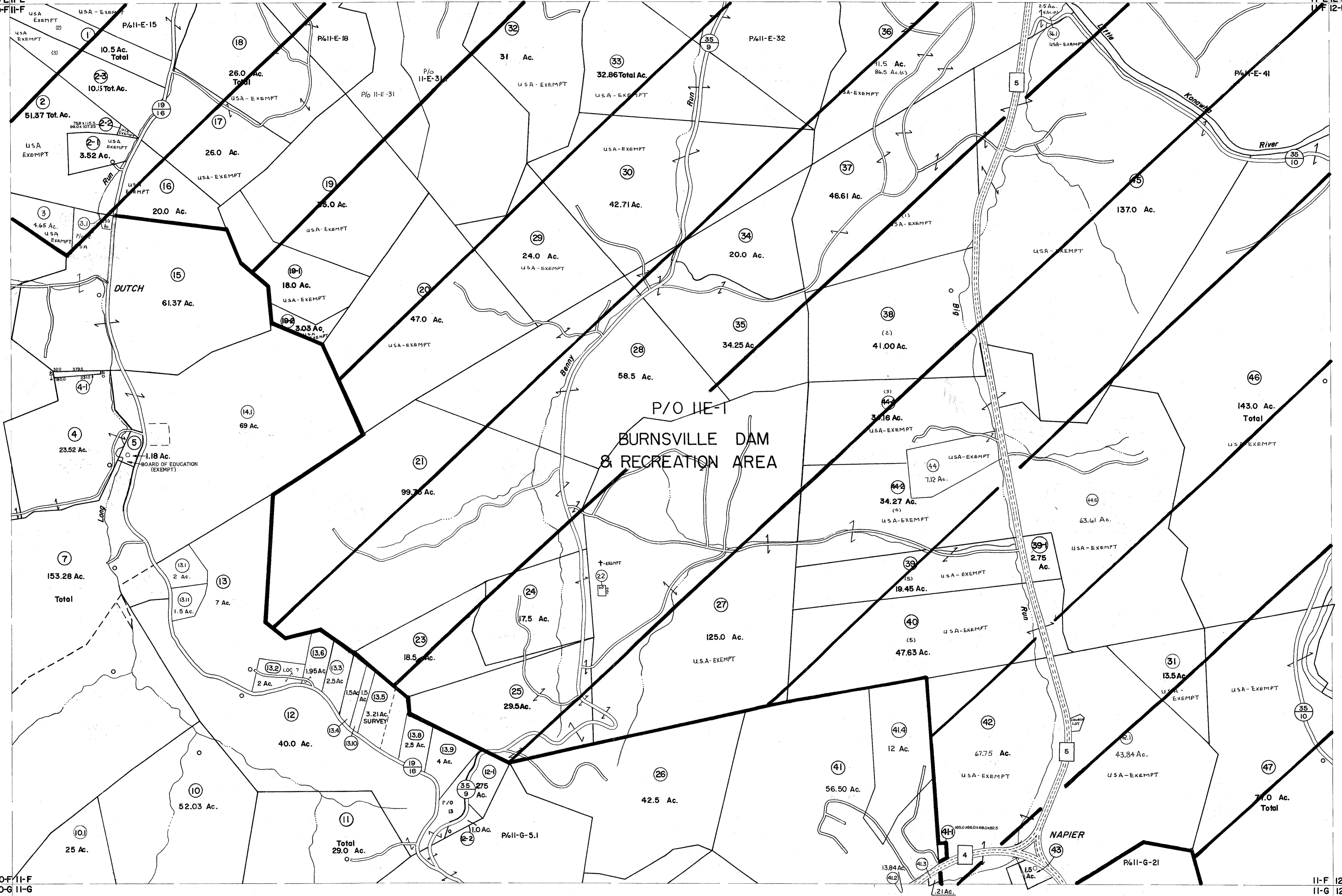

For Tax Purposes Only

Prepared by  
**VOGT, IVERS AND ASSOCIATES**  
 ENGINEERS-ARCHITECTS  
 CHARLESTON, W.VA.  
 CINCINNATI, OHIO

Property line  
 Edge of pavement or roadway  
 Corporation line  
 District line  
 County line

Original lot line  
 Deed lot number  
 Parcel or index number  
 Improvement  
 Railroad

Revisions			
1	PARCELS 2-1, 2-2, 2-3, 9-1, 9-1, 9-2,	9	7-1-84 L.E.S.
2	4H, 44-1, 44-2, 44-3, 44-4	10	Revised to 7-1-85
3	ADDED 6-28-63.	11	Revised to 7-1-85
4	PARCELS 39-1 & 44-5 ADDED	12	EXCALIBUR GRAPHICS 5/93
5	7-2-65	13	O.G.I.S 6-1-96 J.E.B.
6	GOLDEN (J21) 77 T.G.	14	5-1-97 J.E.B.
7	November, 1981 TR	15	4-15-98 J.E.B.
8	Revised to 7-1-85 J.E.B.	16	ESI 4-27-00 REK

KEY MAP  
 10-E 11-E 12-E  
 10-F 11-F 12-F  
 10-G 11-G 12-G

**BRAXTON COUNTY**  
 STATE OF WEST VIRGINIA  
 Office of Assessor

DISTRICT  
**SALT LICK DISTRICT**

SHEET NO: 11-F

Date, Aerial Photography: 4-20-60  
 Photo No: BR-14-75 R 102  
 Date, Map: 1-10-62  
 Scale: 1"=400'