

86-9-G  
9-H

9-G 10-G  
9-H 10-H

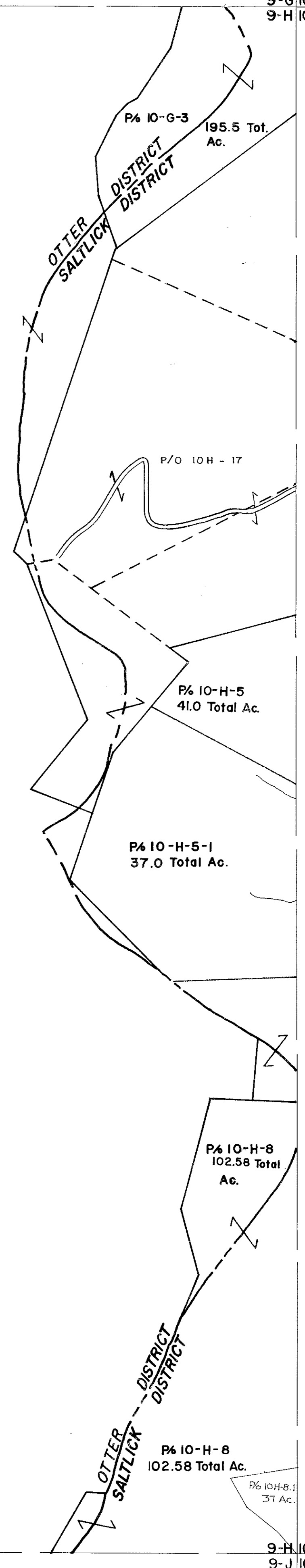

9-H  
9-J

9-H 10-H  
9-J 10-J

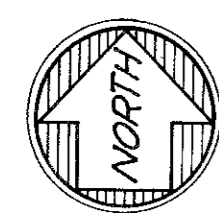

For Tax Purposes Only

Prepared by  
**VOGT, IVERS AND ASSOCIATES**  
 ENGINEERS-ARCHITECTS  
 CHARLESTON, W.VA.  
 CINCINNATI, OHIO

Property line	-----	Original lot line	-----
Edge of pavement or roadway	-----	Deed lot number	(15)
Corporation line	-----	Parcel or index number	(29)
District line	-----	Improvement	o
County line	-----	Railroad	o

Revisions			
1	5-23-77	SRJ	9
2	NOVEMBER, 1981	TRL	10
3	JULY 1, 1983		11
4	7-1-84	L.E.S.	12
5	Revised to 7-1-86		13
6	July, 1987	TRL	14
7	5-1-97	J.E.B.	15
8			16

KEY MAP

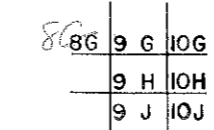

BRAXTON COUNTY

STATE OF WEST VIRGINIA

Office of Assessor

DISTRICT  
**SALT LICK DISTRICT**

SHEET NO: 9-H

Date, Aerial Photography: 4-22-60 Date, Map: 4-24-62  
 Photo No. BR-14-117 Scale: 1" = 400'