

12C 13C  
12D 13D

13C  
13D 14D

12D 13D  
12E 13E

13D 14D  
13E 14E

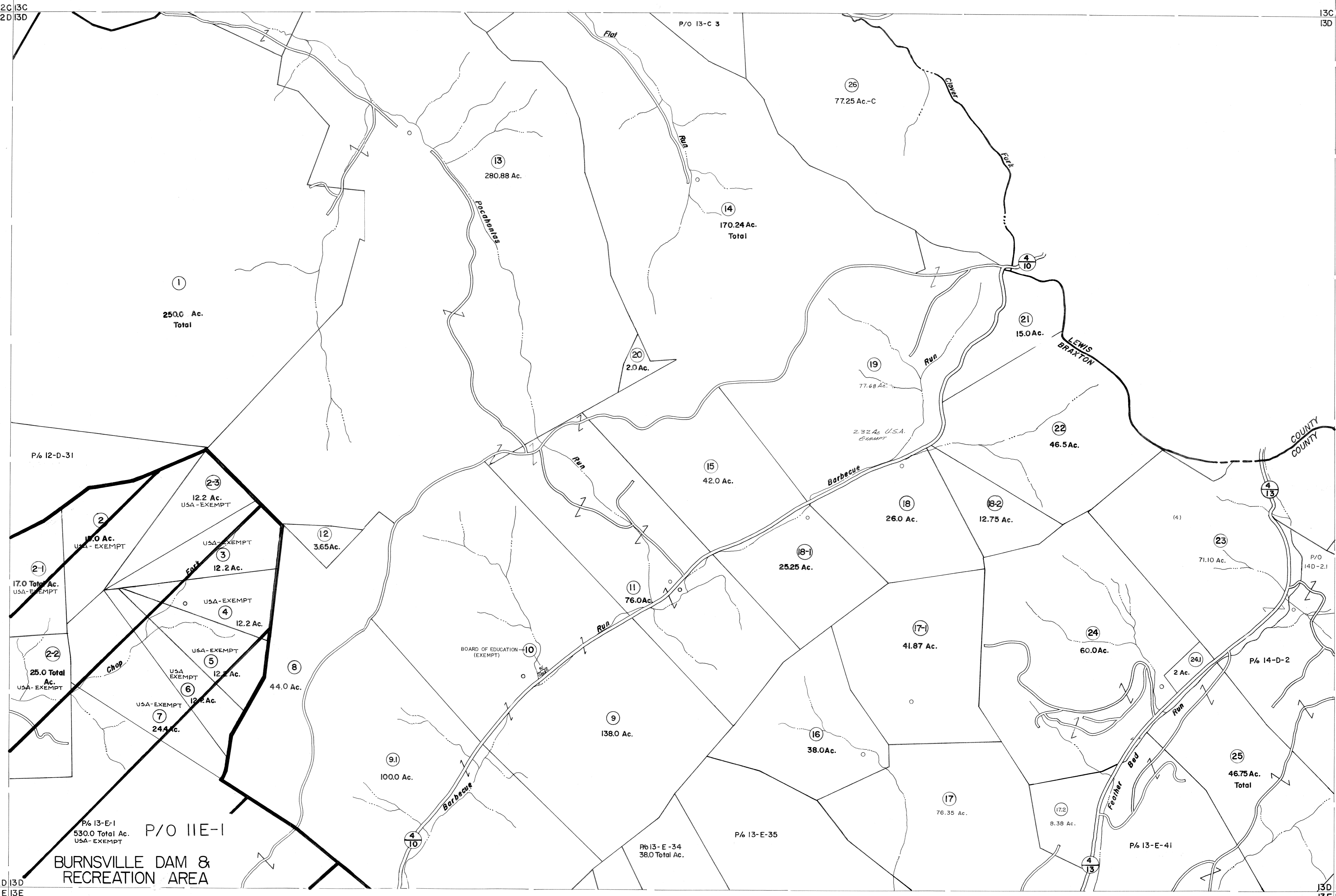

For Tax Purposes Only

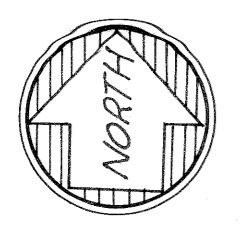

Prepared by  
**VOGT, IVERS AND ASSOCIATES**  
 ENGINEERS-ARCHITECTS  
 CHARLESTON, W.VA.  
 CINCINNATI, OHIO

Property line  
 Edge of pavement or roadway  
 Corporation line  
 District line  
 County line

Original lot line  
 Deed lot number  
 Parcel or index number  
 Improvement  
 Railroad

| Revisions |                                      |
|-----------|--------------------------------------|
| 1         | PARCELS 2-1, 2-2, 2-3, 17-1, 18-1, 9 |
| 2         | 18-2 ADDED 6-26-63 10                |
| 3         | PARCEL 9-1 ADDED 7-2-63 11           |
| 4         | 5-16-77 SRJ 12                       |
| 5         | November, 1981 TRL 13                |
| 6         | Revised 10-1-83 SF 14                |
| 7         | 7-1-84 L.E.S. 15                     |
| 8         | Revised 1-1-89 SF 16                 |
| 9         | OGIS 2/11/91 DSH 17                  |
| 10        | O.G.I.S. 6-1-96 J.E.B. 18            |
| 11        | 5/7/05 S.B.H. 19                     |
| 12        | 4/15/07 S.B.H. 20                    |
| 13        |                                      |
| 14        |                                      |
| 15        |                                      |
| 16        |                                      |
| 17        |                                      |
| 18        |                                      |
| 19        |                                      |
| 20        |                                      |
| 21        |                                      |
| 22        |                                      |
| 23        |                                      |
| 24        |                                      |

KEY MAP

12C 13C  
 12D 13D 14D  
 12E 13E 14E

**BRAXTON COUNTY**  
 STATE OF WEST VIRGINIA  
 Office of Assessor

DISTRICT  
**SALT LICK DISTRICT**

SHEET NO: 13-D

Date, Aerial Photography: 4-20-60 Date, Map: 4-24-62  
 Photo No: BR-14-39 Scale: 1" = 400'