

For Tax Purposes Only  
 Prepared by  
 McKenzie Engineering Corporation  
 806 Broad Street  
 Summersville, WV 26651

LEGEND	
Property line	Original lot line
Edge of pavement or roadway	Deed lot number (15)
Corporation line	Parcel or Index number (99)
District line	Improvement
County line	Railroad

REVISIONS
1
2
3
4
5
6
7
8

RESTRICTION

All tax maps created under the provisions of reappraisal legislation are the property of Clay County West Virginia and the reproduction, copying, distribution or sale of such tax maps or any copies thereof without the written permission of the Clay County Assessor is prohibited by law.

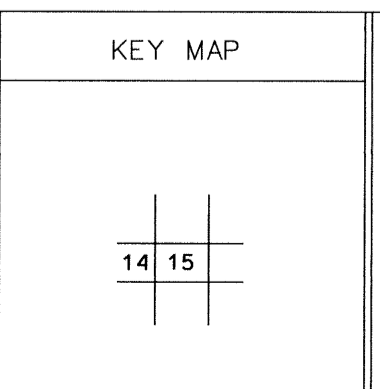

CLAY COUNTY  
 STATE OF WEST VIRGINIA  
 Office of Assessor

PLEASANT DISTRICT  
 SHEET NO:15  
 Date, Aerial Photography: 4-6-63  
 Photo No: 18-1660, 1661, 1662, 1663  
 19-1684, 1685, 1686  
 Date, Map: 6-8-65  
 Scale: 1" = 400'