





FOR TAX PURPOSES ONLY
LANDMARK
 geospatial
A Division of Landmark Forestry LLC

Legend		
	District Boundary	
	Previous Deed	
	Property	
	Road Easement	
	Railroad Right of Way	
	Road Right of Way	
	River	
	Jeep Trail	
	Deed lot Number	(15)
	Parcel or Index Number	
	Unknowns	
	Improvement	
	Cemetery	
	Church	
	Educational	

Restriction

All tax maps created under the provisions of reappraisal legislation are the property of the Assessor of Clay County, West Virginia and the reproduction, copying, modification, distribution or sale of such tax maps or any copies thereof without the written permission of the Clay County Assessor is prohibited by law.

Revisions					
1	LANDMARK	01/2014	10	19	28
2			11	20	29
3			12	21	30
4			13	22	31
5			14	23	32
6			15	24	33
7			16	25	34
8			17	26	35
9			18	27	36

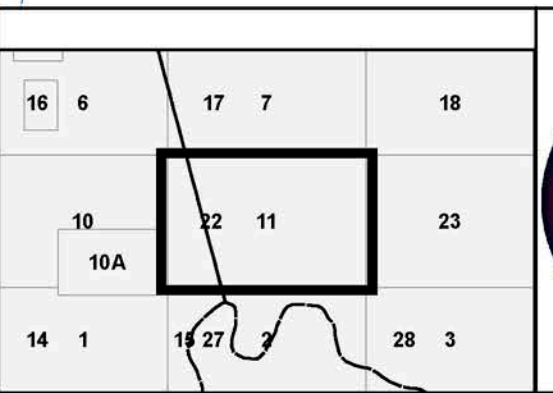

CLAY COUNTY
 Assessor's Office
 Teresa Lane, Assessor
 CLAY, WV

UNION
 District 06 Map No. 11
 Date of Publication: 2/5/2014
 Scale: 1"=400'