

8  
12

8 9  
12 13

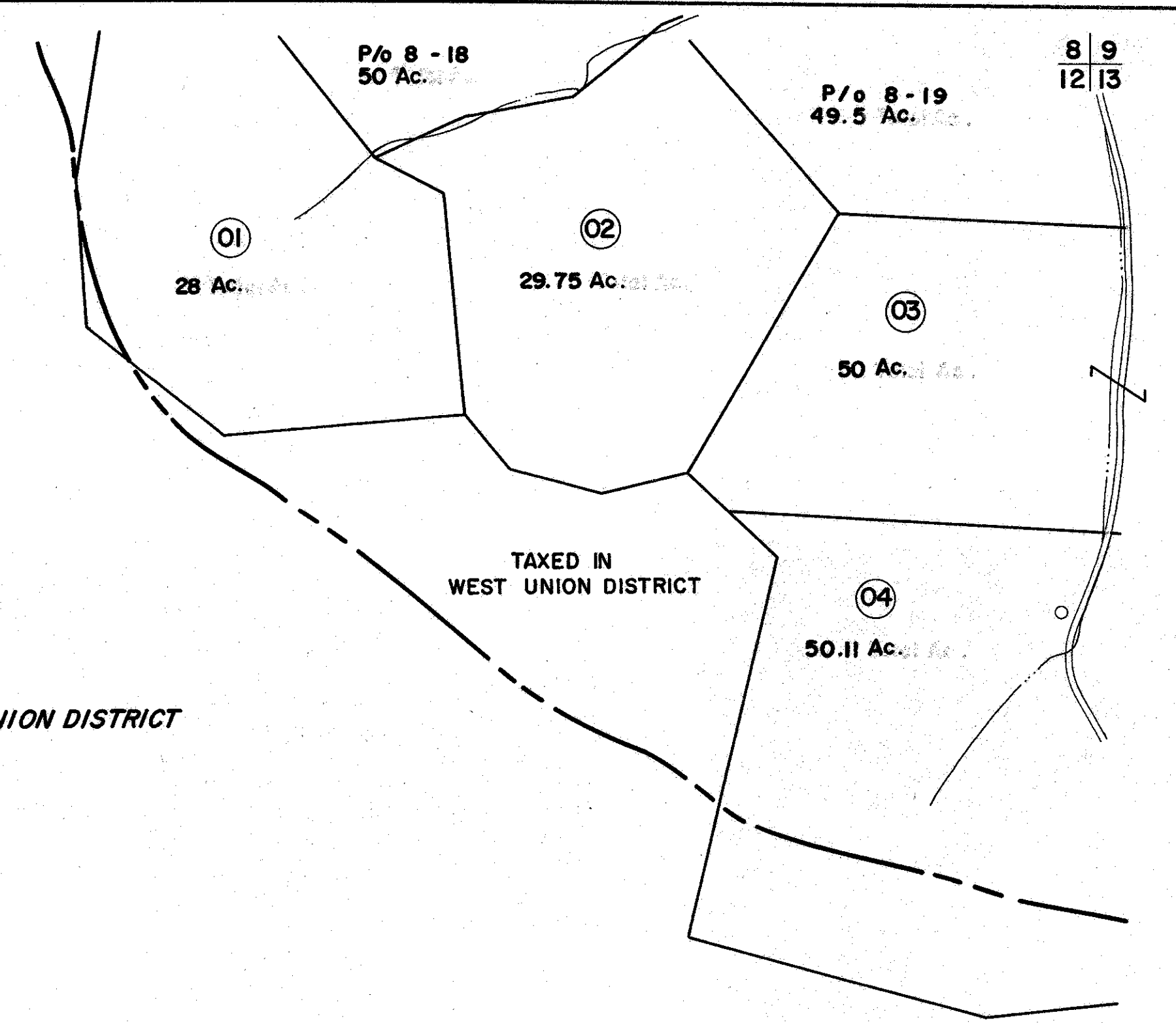

WEST UNION DISTRICT

TAXED IN  
WEST UNION DISTRICT

12

12 13  
15



FOR TAX PURPOSES ONLY

Prepared by  
**L. ROBERT KIMBALL**  
 Consulting Engineer  
 Ebensburg, Pennsylvania

Legend	
Property line	Original lot line
Edge of pavement or roadway	Deed lot number in parenthesis
Corporation line	Parcel or index number in circle
District line	Improvement
County line	Railroad

Revisions				
1	REVISED	7-81	T. Groves	17
2	OGIS	1-11-91	JB	18
3				19
4				20
5				21
6				22
7				23
8				24

STATE OF WEST VIRGINIA  
 DODDRIDGE COUNTY  
 Office of Assessor

GRANT DISTRICT  
 SHEET 12

Date, Aerial Photography: APRIL, 1962 Date, Map: OCT, 1963  
 Photo No: 254 Scale: 1" = 400'

156 MATERIAL, A.B. SMITH CO., PCH., PA. 15244-1262