

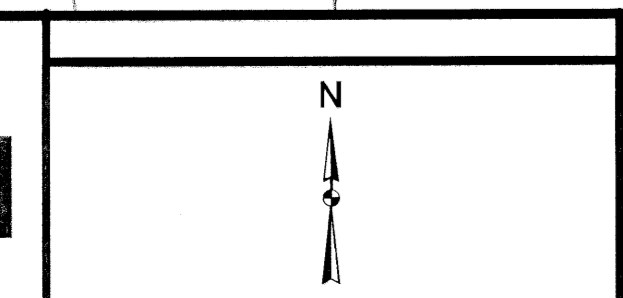

For Tax Purposes Only
 Kimball



- Legend**
- Original Lot Line
 - Property
 - Hydrology
 - Road and Railroad RW
 - Road Easement
 - Road Right of Way

- Route Number (16)
- Lot Number (11)
- Parcel Number (12)
- Parcel Hook (1)
- District (---)

Revisions	
1	7
2	8
3	9
4	10
5	11
6	12

7	8	9
13	14	15
19	20	21

STATE OF WEST VIRGINIA
DODDRIDGE COUNTY
 Office of Assessor

District
MCCLELLAN

SHEET NO: 14

Date, Aerial Photography: _____ Date Map: _____
 Photo No: _____ Scale: 1" = 400'