

04-0011

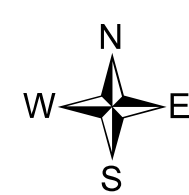
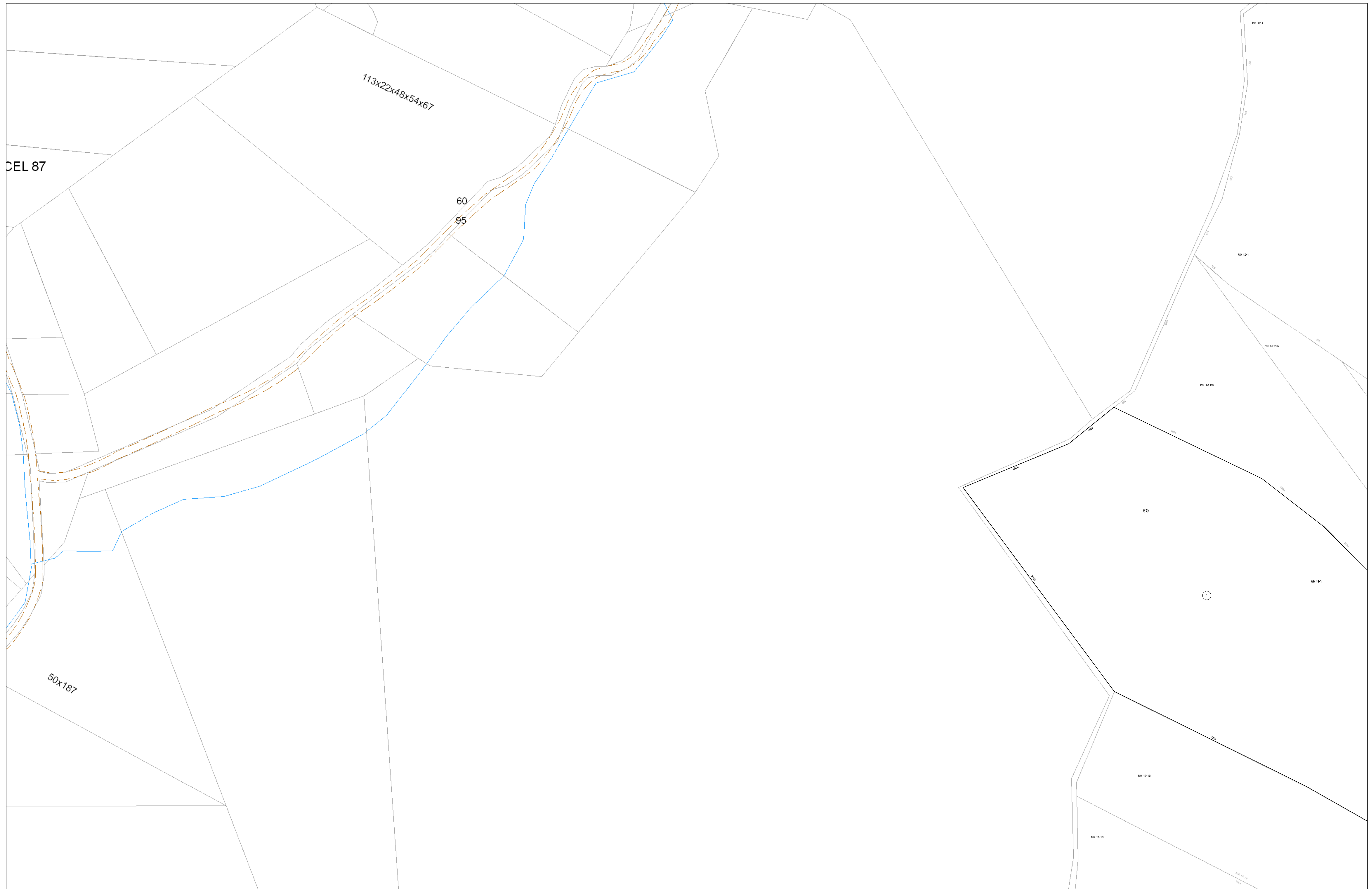

FOR TAX PURPOSES ONLY

Prepared By:
Eddie Young
 Fayette County Assessor

Legend

Property Line	—————	Original Lot Line	—————
Edge of pavement or roadway	- - - - -	Deed lot number (in parenthesis)	(15)
Corporation line	Parcel or index number	Ⓜ
District line	Improvement	○
County Line	Railroad	—+—+—+—

Restriction

All tax maps created under the provisions of reappraisal legislation are the property of the Assessor of Fayette County, West Virginia and the reproduction, copying, modification, distribution sale of such tax maps or any copies thereof without the written permission of the Fayette County Assessor is prohibited by law.

17	1	2	3	33
	4	5	6	18
	8	9	10	
24	12	13	14	25A
	16	17	18	19
	20	21	22	25B
32				33

FAYETTE COUNTY - WEST VIRGINIA
 Office of Assessor

District: Ansted Corp
Map No: 04-0011
Drawn By:
Date: Feb 23, 2007
Scale: 1 inch equals 100 feet