

09-0016

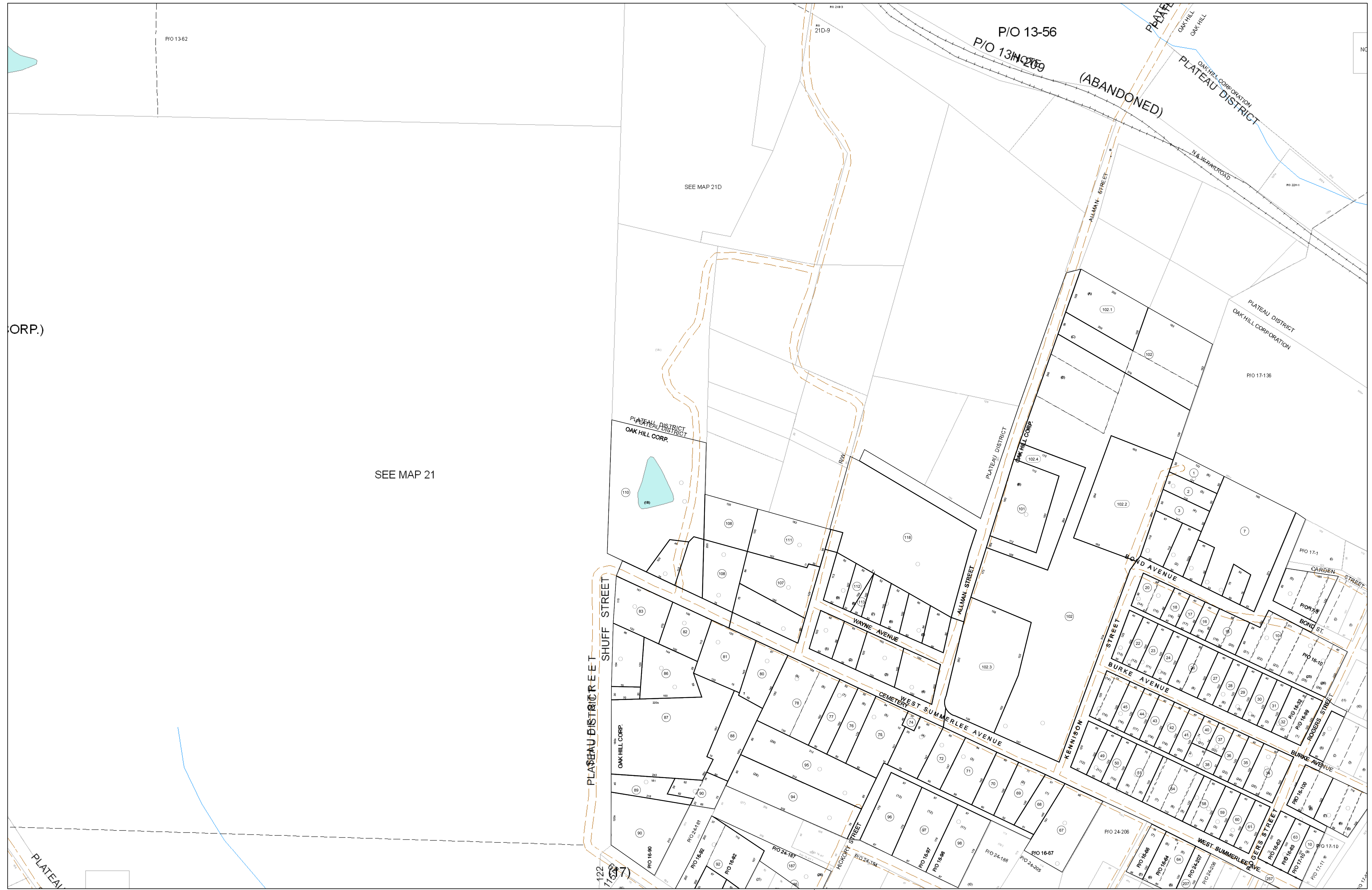

FOR TAX PURPOSES ONLY
 Prepared By:
Eddie Young
 Fayette County Assessor

Legend	
Property Line	—
Edge of pavement or roadway	- - - - -
Corporation line	— · — · —
District line	· · · · ·
County Line	- - - - -
Original Lot Line	—
Deed lot number (in parenthesis)	(15)
Parcel or index number	Ⓜ
Improvement	○
Railroad	—+—+—+—

Restriction

All tax maps created under the provisions of reappraisal legislation are the property of the Assessor of Fayette County, West Virginia and the reproduction, copying, modification, distribution sale of such tax maps or any copies thereof without the written permission of the Fayette County Assessor is prohibited by law.

13	14	15	16	17	18	19	20	21
130	131	132	133	134	135	136	137	138
139	140	141	142	143	144	145	146	147
148	149	150	151	152	153	154	155	156
157	158	159	160	161	162	163	164	165
166	167	168	169	170	171	172	173	174
175	176	177	178	179	180	181	182	183
184	185	186	187	188	189	190	191	192
193	194	195	196	197	198	199	200	201

FAYETTE COUNTY - WEST VIRGINIA
 Office of Assessor

District: Oak Hill Corp
Map No: 09-0016
Drawn By:
Date: Feb 23, 2007
Scale: 1 inch equals 100 feet