

2021

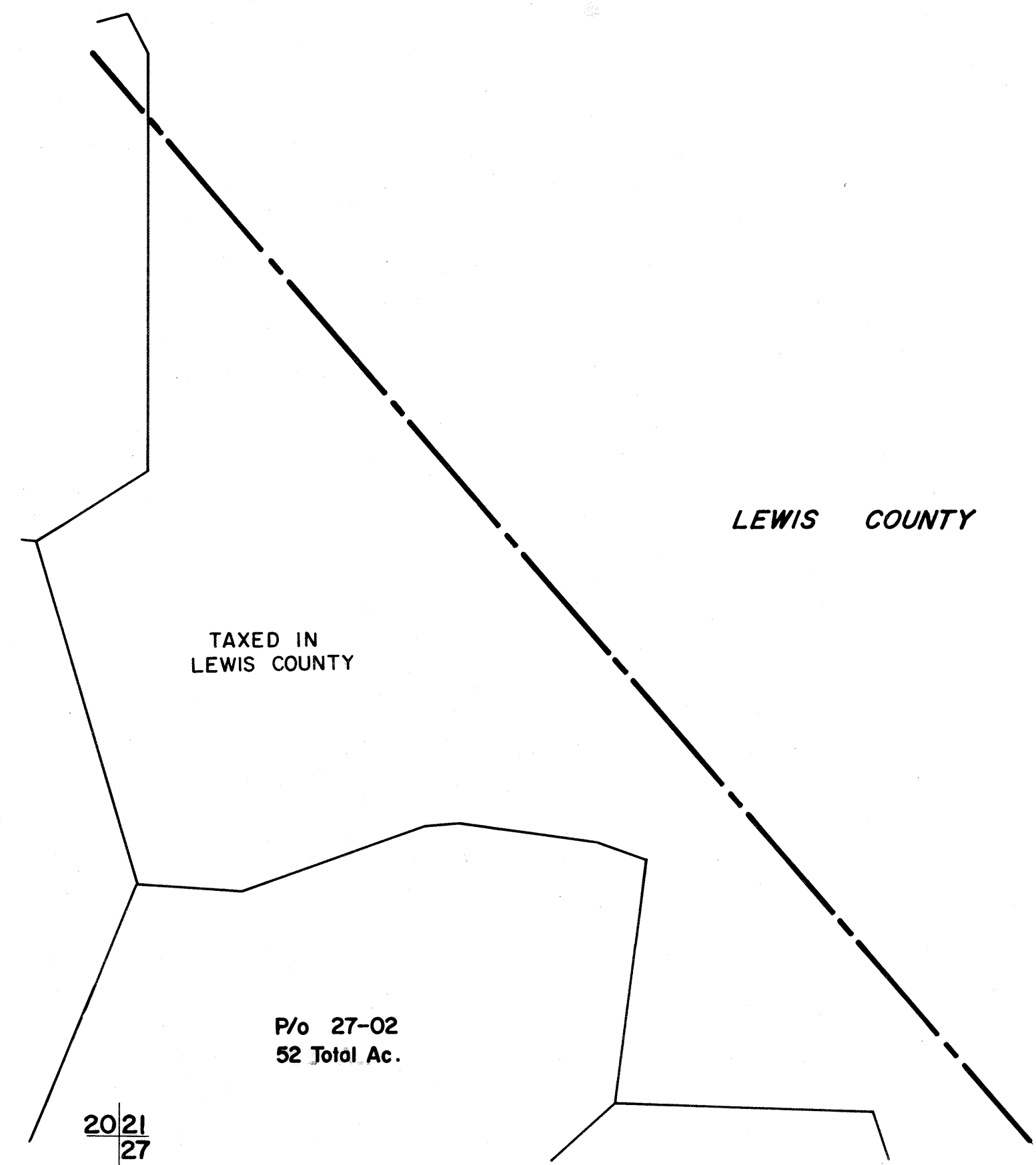

2021
27

FOR TAX PURPOSES ONLY

Prepared by
L. ROBERT KIMBALL
Consulting Engineer
Ebensburg, Pennsylvania

Legend	
Property line	—————
Edge of pavement or roadway	- - - - -
Corporation line
District line
County line	- - - - -
Original lot line
Deed lot number in parenthesis	(15)
Parcel or index number in circle	⊙
Improvement	○
Railroad	+++++

Revisions			
1	Revised to 7-81	9	17
2		10	18
3		11	19
4		12	20
5		13	21
6		14	22
7		15	23
8		16	24

STATE OF WEST VIRGINIA
COUNTY OF GILMER
Office of Assessor

**GLENVILLE DISTRICT
SHEET 21**

Date, Aerial Photography: MAY, 1961 Date, Map: MAR., 1963
Photo No: 289 Scale: 1"=400'

