

22  
26 27

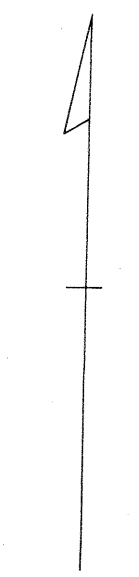
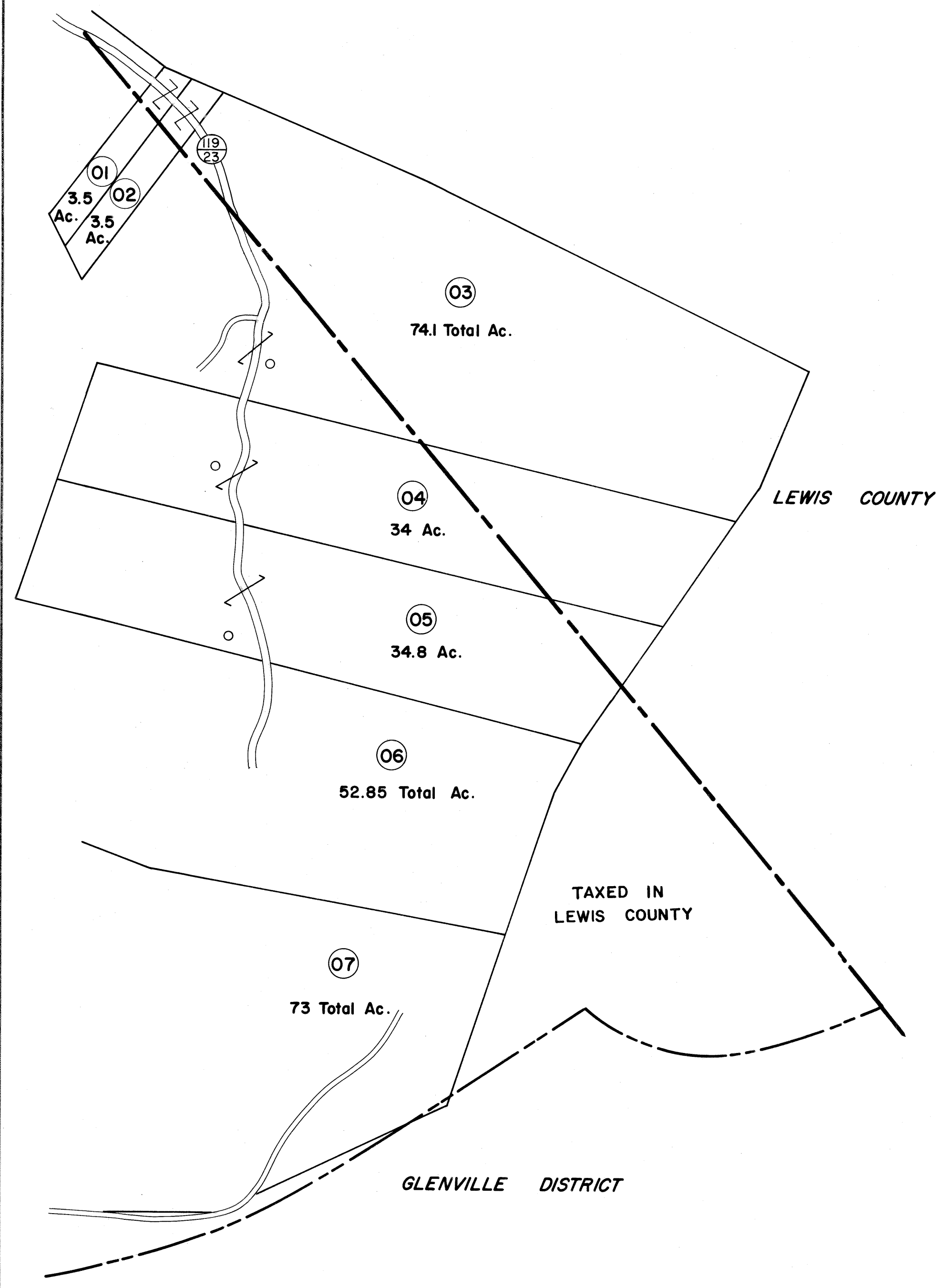

2627

FOR TAX PURPOSES ONLY

Prepared by  
**L. ROBERT KIMBALL**  
*Consulting Engineer*  
 Ebensburg, Pennsylvania

Legend

Property line	—————	Original lot line	.....
Edge of pavement or roadway	-----	Deed lot number in parenthesis	(15)
Corporation line	-----	Parcel or index number in circle	Ⓣ
District line	-----	Improvement	○
County line	-----	Railroad	+

Revisions

No.	Date	Description	No.	Date	Description
1	JULY, 1981	TRL	9		
2			10		
3			11		
4			12		
5			13		
6			14		
7			15		
8			16		
			17		
			18		
			19		
			20		
			21		
			22		
			23		
			24		

STATE OF WEST VIRGINIA  
 COUNTY OF GILMER  
 Office of Assessor

TROY DISTRICT  
 SHEET 27

Date, Aerial Photography: MAY, 1961  
 Date, Map: DEC., 1962  
 Photo No: 310  
 Scale: 1" = 400'