

FOR TAX PURPOSES ONLY

Prepared By:
Ralph Layton
 Grant County Assessor

Legend

Property Line	—	Original Lot Line	- - - - -
Road Right of Way	—	Lot Number (15)	(15)
Corporation Line	—	Parcel Number (99)	(99)
District Line	—	Water	—
County Line	—	Railroad	—

R	11	Revised 10/1/16	9	17
O	2	Revised 12/30/2016	10	18
V	3		11	19
I	4		12	20
S	5		13	21
I	6		14	22
N	7		15	23
S	8		16	24

STATE OF WEST VIRGINIA
COUNTY OF GRANT
 Office of Assessor

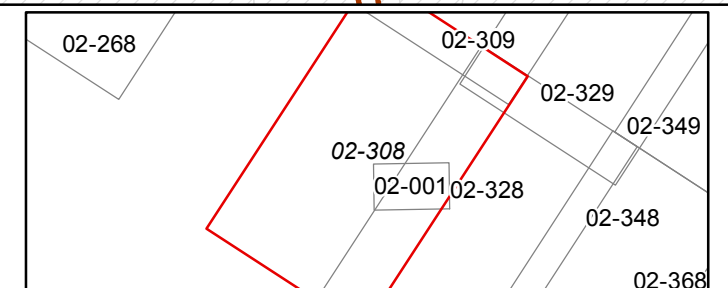

GRANT
 Map: 308
 Date, Aerial Photography: 2015
 Date, Map: 1/25/2017
 Scale: 1" = 400'