

SEE INSERT BELOW

INSERT (1"=200')

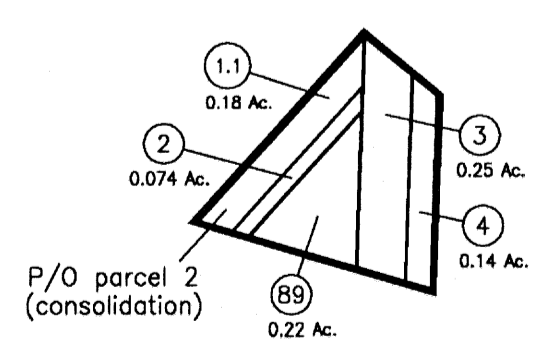

For Tax Purposes Only
Greenbrier County
Assessor's Office

Legend	
Property line	———
Roads	====
Streams	~~~~~
Land hook	Z
Parcel number	(10)
Lot number	(5)
Consolidated	△
Parcel number	△
Property line	———

Restrictions

All tax maps created under the provisions of reappraisal legislation are the property of the State of West Virginia and the reproduction, copying, distribution or sale of such tax maps or any copies thereof without the written permission of the State Tax Commissioner is prohibited by law.

plotted Nov 2005

35	36	37
39	40	41
	42	

Greenbrier County
State of West Virginia
Lewisburg, West Virginia

Blue Sulphur
District
40
scale: 1 inch = 400 feet