

See Fort Spring District
Map 19, 1"=400'

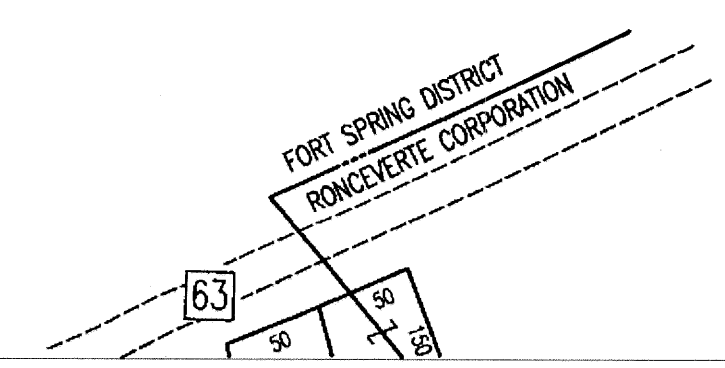

For Tax Purposes Only

Greenbrier County
Assessor's Office

Legend

Property line	=====	Parcel number	⑩
Roads	=====	Lot number	(5)
Streams	-----	Consolidated	△
Land hook	Z	Parcel number	
		Property line	—————

Restrictions

All tax maps created under the provisions of reappraisal legislation are the property of the State of West Virginia and the reproduction, copying, distribution or sale of such tax maps or any copies thereof without the written permission of the State Tax Commissioner is prohibited by law.

plotted Nov 2005

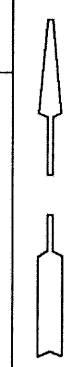

	9N	14K
12R	19C	
19K	19G	

Greenbrier County
State of West Virginia
Lewisburg, West Virginia

Fort Spring
District
19C

scale: 1 inch = 100 feet