

WV LEGISLATIVE REGULATION
TITLE 189 SERIES 2009

Disclaimer:
This tax map was compiled for purposes of taxation from available record evidence and has not been field verified. This map is not a valid survey plat and the data on this map does not imply any official status to such data. The State of West Virginia and county assessors's office assume no liability that might result from the use of this map.

Restrictions:
All finished tax maps created under the provisions of legislation are the property of the county assessors who created them and the reproduction, copying, distribution, sale, or lease of such tax maps or copies thereof without the written permission of the respective county assessors is prohibited by law.

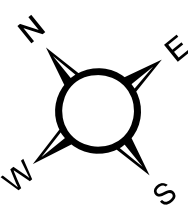

Legend			
Corporation line	---	Railroad	—+—+—+—
District line	---	Lot line	---
County line	---	Road Centerline	---
State line	---	Streams	---
Property Line	---	Trans Line	---
Right of Way	---	Cemetery	---
		School	---
		Church	---
		Deed lot number	(25)
		Parcel or index number	(23)
		Parcel acreage	5.27 Ac.

Revisions					
1	AS OF JULY 1 1996	KWS	6	AS OF JULY 1 2001	JVB
2	AS OF JULY 1 1997	KWS	7	AS OF JULY 1 2002	JVB
3	AS OF JULY 1 1998	JVB	8	AS OF JULY 1 2003	JVB
4	AS OF JULY 1 1999	JVB	9	AS OF JULY 1 2004	JVB
5	AS OF JULY 1 2000	JVB	10	AS OF JULY 1 2005	JVB
			11	AS OF JULY 1 2007	JVB
			12	AS OF JULY 1 2008	RIR
			13	AS OF JULY 1 2011	ASC
			14	AS OF MAR 29 2012	ASC
			15	AS OF JAN 1 2013	ASC
			16	AS OF JAN 1 2014	ASC
			17	AS OF JAN 1 2015	ASC
			18	AS OF JAN 1 2017	ASC

STATE OF WEST VIRGINIA
COUNTY OF HAMPSHIRE
Office of Assessor

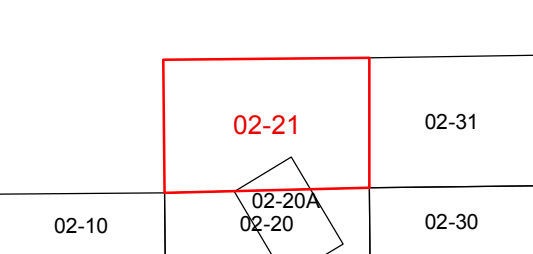

Capon
Map: 21
Created: 1/23/2017
Scale: 1 in = 400 ft