

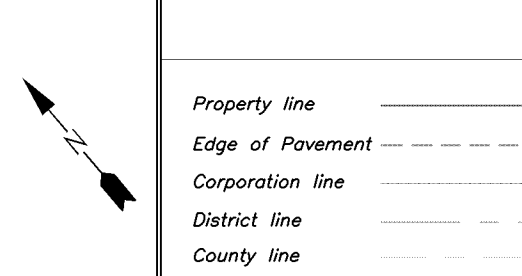

WV LEGISLATIVE REGULATION
 TITLE 189 SERIES 5 1991
 ARTICLE 5 SECTION 5.1
 Reproduction of tax maps prohibited -
 No person may reproduce, copy, distribute
 or sell copies of tax maps prepared by
 the counties without having first obtained
 the written permission of the county
 assessor.



Legend

Original lot line
 Deed lot number in parenthesis (15)
 Parcel or index number 999.3
 Improvement
 Railroad

Revisions			
1	AS OF JULY 1 1996	KWS	9
2	AS OF JULY 1 1997	KWS	10
3	AS OF JULY 1 1999	JVB	11
4	AS OF JULY 1 2000	JVB	12
5	AS OF JULY 1 2001	JVB	13
6	AS OF JULY 1 2002	JVB	14
7	AS OF JULY 1 2003	JVB	15
8	AS OF JULY 1 2004	JVB	16
9	AS OF JULY 1 2005	JVB	17
10	AS OF JULY 1 2006	JVB	18

MAP REFERENCE		
	30	
19	29	39
18	28	38

HAMPSHIRE COUNTY - WEST VIRGINIA
 Office of Assessor
 For Tax Purposes Only

CAPON

Map No.: 29 FILE NAME:
 Aerial Photography: 4/59 Date of Map: 10/59
 Photo No.: 10-9 Scale: 1 inch = 400 ft