

WV LEGISLATIVE REGULATION
 TITLE 189 SERIES 5 1991
 ARTICLE 5 SECTION 5.1
 Reproduction of tax maps prohibited -
 No person may reproduce, copy, distribute
 or sell copies of tax maps prepared by
 the counties without having first obtained
 the written permission of the county
 assessor.

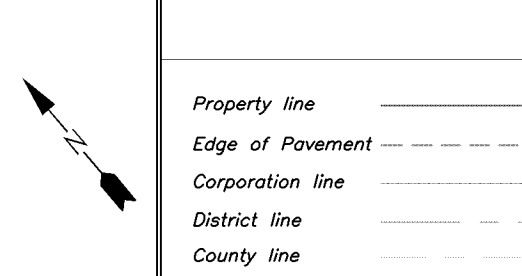

Legend

Original lot line
 Deed lot number in parenthesis (15)
 Parcel or index number 9993
 Improvement
 Railroad

Revisions

1 AS OF JULY 1 1996	KWS	9	AS OF JULY 1 2005	JVB
2 AS OF JULY 1 1997	KWS	10	AS OF JULY 1 2006	JVB
3 AS OF JULY 1 1999	JVB	11		
4 AS OF JULY 1 2000	JVB	12		
5 AS OF JULY 1 2001	JVB	13		
6 AS OF JULY 1 2002	JVB	14		
7 AS OF JULY 1 2003	JVB	15		
8 AS OF JULY 1 2004	JVB	16		

MAP REFERENCE

21	31
20	30

HAMPSHIRE COUNTY - WEST VIRGINIA
 Office of Assessor
 For Tax Purposes Only

CAPON

Map No.: 31 FILE NAME:
 AS OF JULY 1 2008 Aerial Photography: 4/59 Date of Map: 10/59
 Photo No.: 10-11 Scale: 1 inch = 400 ft