

SEE LOUDON DIST.
MAP 4B

P/O 6C-173

SEE MAP 6C

SEE LOUDON 4D

SEE MAP 5 PARS. 68, 74, 75, 76, 77, & 78 LOUDON DISTRICT
Scale: 1" = 400'

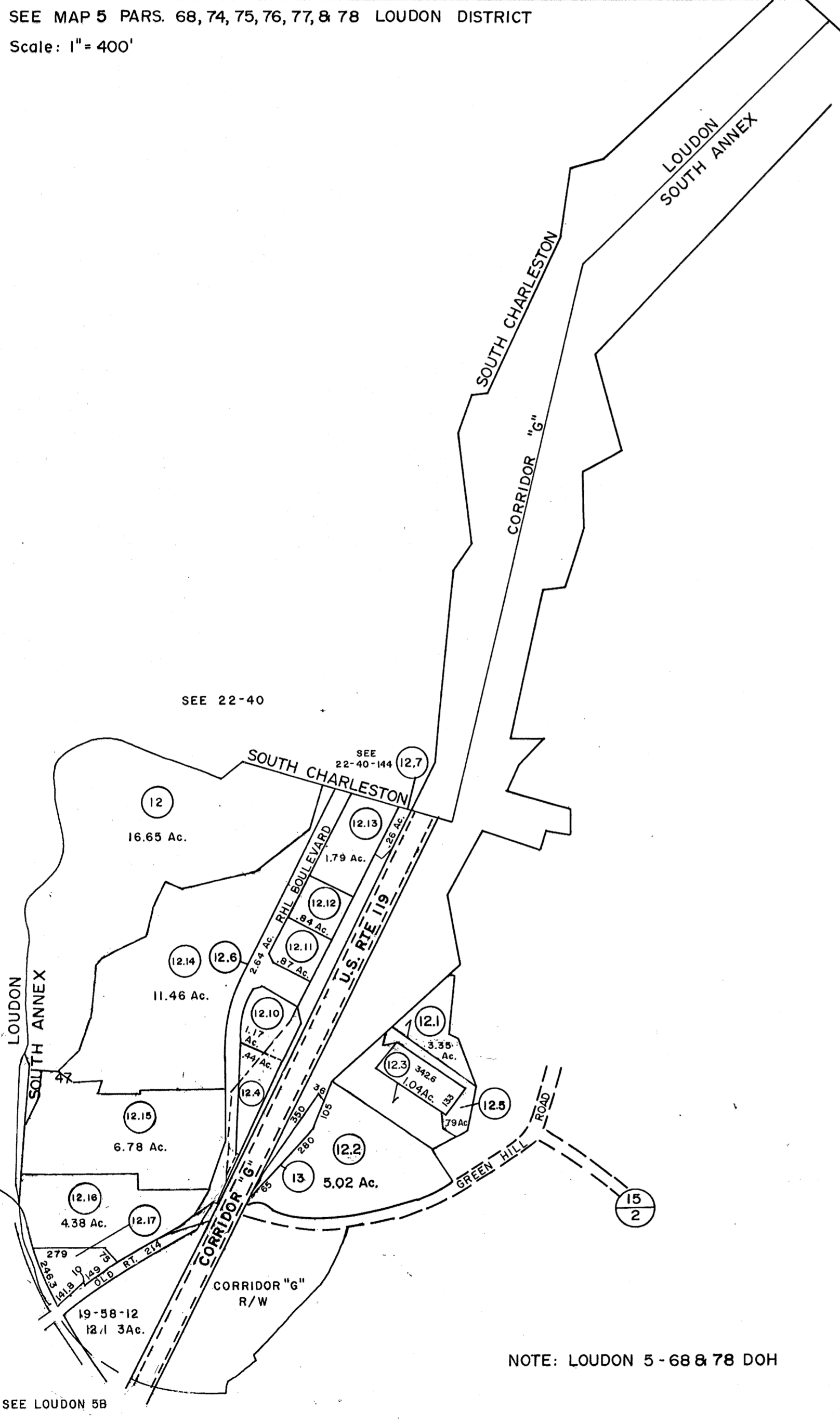

SEE LOUDON MAP 4H

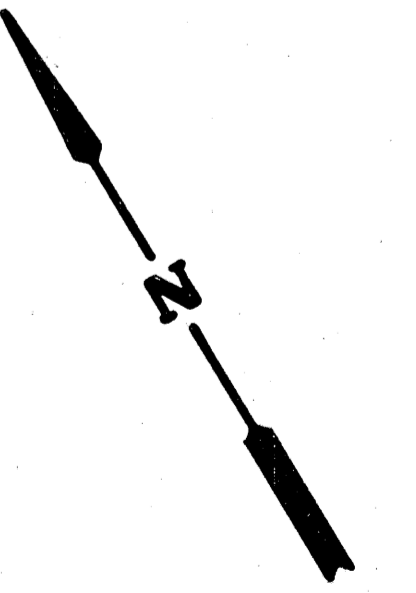

For Tax Purposes Only

Prepared by
STATE TAX DEPARTMENT
STATE TAX COMMISSIONER
CHARLESTON, WV.

LEGEND	
Property line	———
Edge of pavement or roadway	———
Corporation line	———
District line	———
County line	———
State line	———
Land hook	———
Water	———

LEGEND	
Original lot line	———
Deed lot number	(15)
Parcel or index number	(15)
Improvement	○
Railroad	———
Scaled dimension	(5)
Deed dimension	(D)
Calculated area	(C)

REVISIONS	
New Map to 7-1-89 DR. 11-2-89 D.F.F.	
OGIS 6/26/92 DSH	
O.G.I.S 2-15-96 J.E.B	
11-1-97 J.E.B	
12-4-99 J.A.B.	
1-9-2001 J.A.B.	
1-15-08 J.A.B.	

RESTRICTION

All tax maps created under the provisions of reappraisal legislation are the property of the State of West Virginia and the reproduction, copying, distribution or sale of such tax maps or any copies thereof without the written permission of the State Tax Commissioner is prohibited by law.

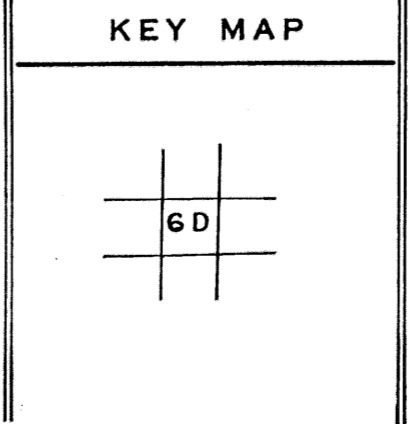

KANAWHA COUNTY
Office of Assessor
CHARLESTON, WEST VIRGINIA

CHARLESTON SOUTH ANNEX - 9
Map No. 6D
Date, Aerial Photography: _____ Date, Map: _____
Photo No: _____ Scale: 1" = 100'