



17-7

17-8

17-10

17-22

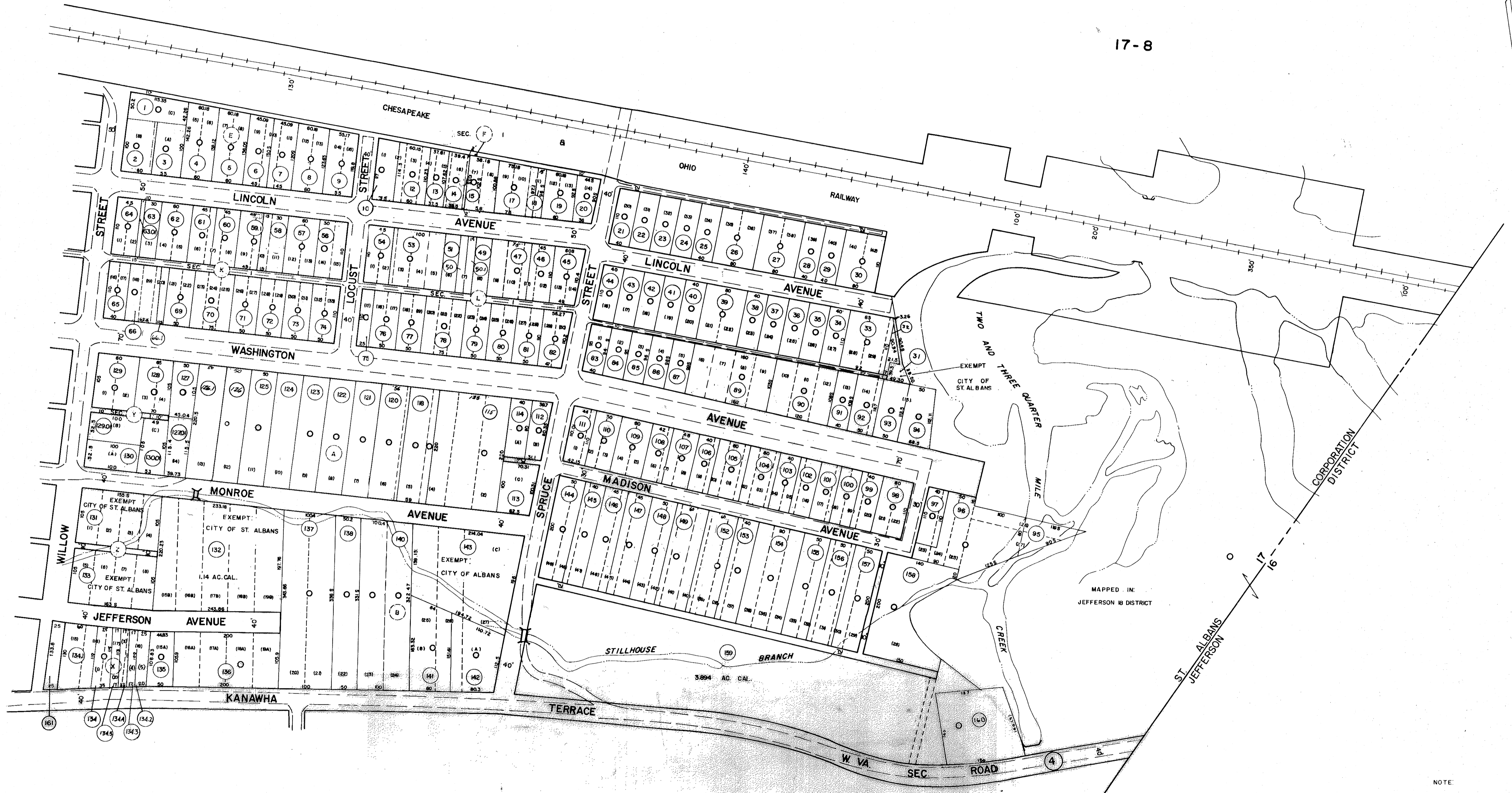

NOTE:
PARCEL NOS. 16,32,67,68 NOT USED

DRAFTED BY: *AM*
CHECKED BY: *WJR*

FOR TAX PURPOSES ONLY

PREPARED BY

AERO SERVICE CORPORATION
A DIVISION OF LITTON INDUSTRIES
210 E. COURTLAND ST. PHILADELPHIA, PA. 19120



AMERICAN AIR SURVEYS, INC.
907 PENN AVENUE, PITTSBURGH 22, PA.
NEW YORK ATLANTA

Legend

Property line	Original lot line	Dead lot number (in parenthesis)
Right of way line	Parcel or index number (in circle)	Improvement
Edge of pavement or roadway	Corporation line	Railroad
Corporation line	District line	Scaled Dimension
District line	County line	Original block number
County line	Stream	CALCULATED AREA

Revisions

1	NICELY 9-74	PAM	9	3-1-97	J.E.B.	17
2	2/22/76	J.C.	10	1-1-99	J.E.B.	18
3	2-1-79		11			19
4	REVISED 7-1-82		12			20
5	REVISED 7-1-85		13			21
6	JULY, 1987	TRL	14			22
7	REV. TO 7-1-89	NCS	15			23
8	O.G.I.S. 4-1-94	J.E.B.	16			24

KANAWHA COUNTY
Office of Assessor
CHARLESTON, WEST VIRGINIA

ST. ALBANS CORPORATION - 17

Map No. 9

Photo No.: 1014

Scale: 1" = 100'

Date, Photography: April, May 1964

Date, Map: 2-26-65