

20 - 3

20 - 5

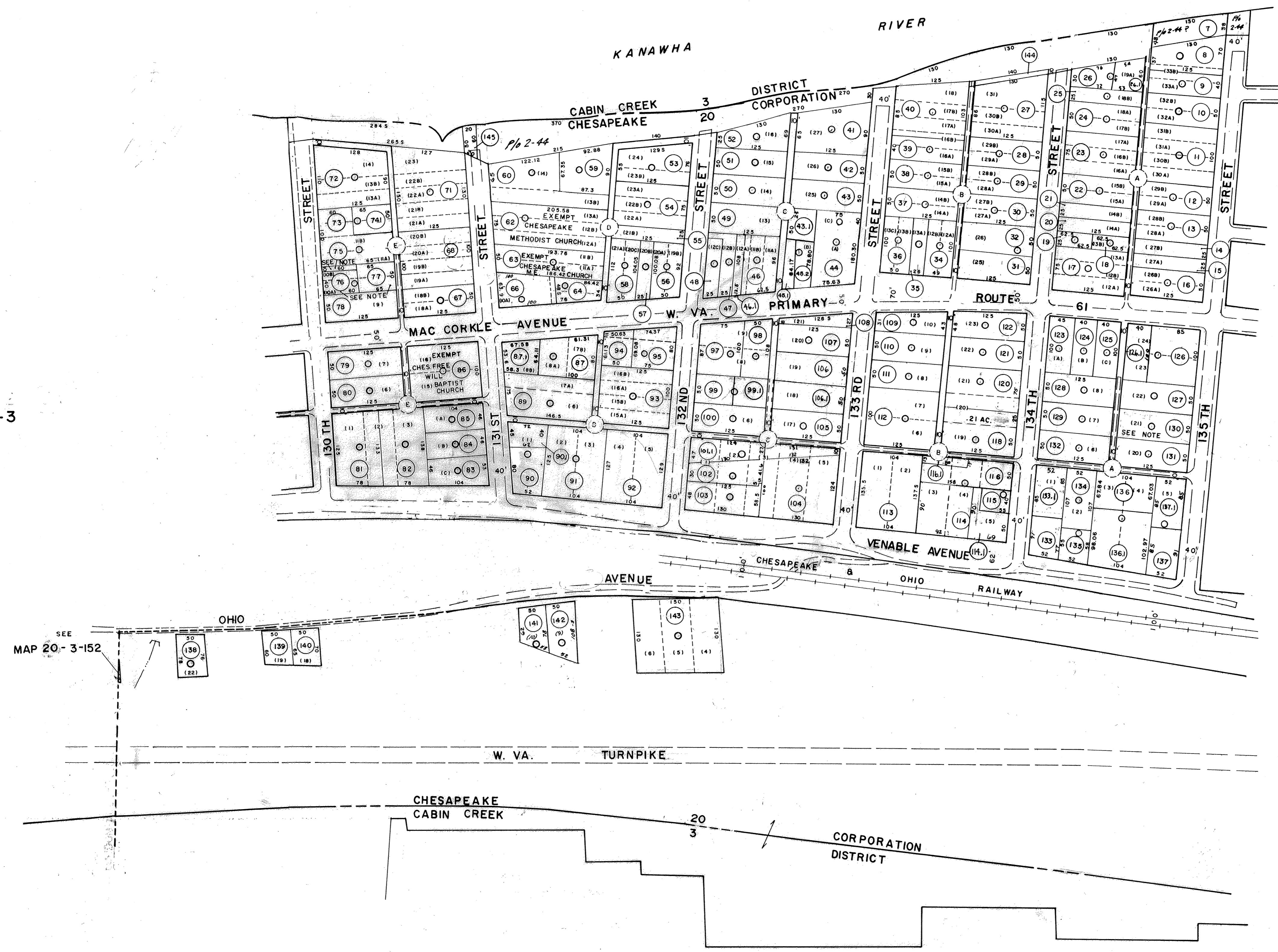

NOTE:
 PARCEL NO. 75 - EXEMPT CHURCH
 PARCEL NO. 76 - EXEMPT CHESAPEAKE MISSIONARY BAPTIST CHURCH
 PARCEL NO. 77 - EXEMPT CHESAPEAKE FIRST BAPTIST CHURCH
 PARCEL NO. 130 - EXEMPT WILLS MEN FREE WILL BAPTIST CHURCH
 PARCEL NO. 96 - NOT USED.

DRAFTED BY: C.T.
 CHECKED BY: E.S.

FOR TAX PURPOSES ONLY
 PREPARED BY
AERO SERVICE CORPORATION
 A DIVISION OF LITTON INDUSTRIES
 210 E. COURTLAND ST., PHILADELPHIA, PA. 19120

AMERICAN AIR SURVEYS, INC.
 907 PENN AVENUE, PITTSBURGH 22, PA.
 NEW YORK ATLANTA

Legend

Property line	Original lot line	(115)
Right of way line	Dead lot number (in parenthesis)	(116)
Edge of pavement or roadway	Parcel or index number (in circle)	(117)
Corporation line	Improvement	(118)
District line	Railroad	(119)
County line	Scaled Dimension	(120)
Stream	Original block number	(121)

Revisions

1	8/10/76	9	7-30-08 J.A.B.	17
2	1/9/79	10		18
3	8/16/82	11		19
4	8/16/82	12		20
5	July, 1987	13	TRL	21
6	7-1-89	14	TRL	22
7	3-1-97	15	J.E.B.	23
8	2-11-2000 J.A.B.	16		24

KANAWHA COUNTY
 Office of Assessor
 CHARLESTON, WEST VIRGINIA

CHESAPEAKE CORPORATION - 20
 Map No. 4
 Photo No.: 294, 296 Scale: 1" = 100'
 Date, Photography: April, May 1964 Date, Map: 7-28-65