

8-U
8-V 9-V

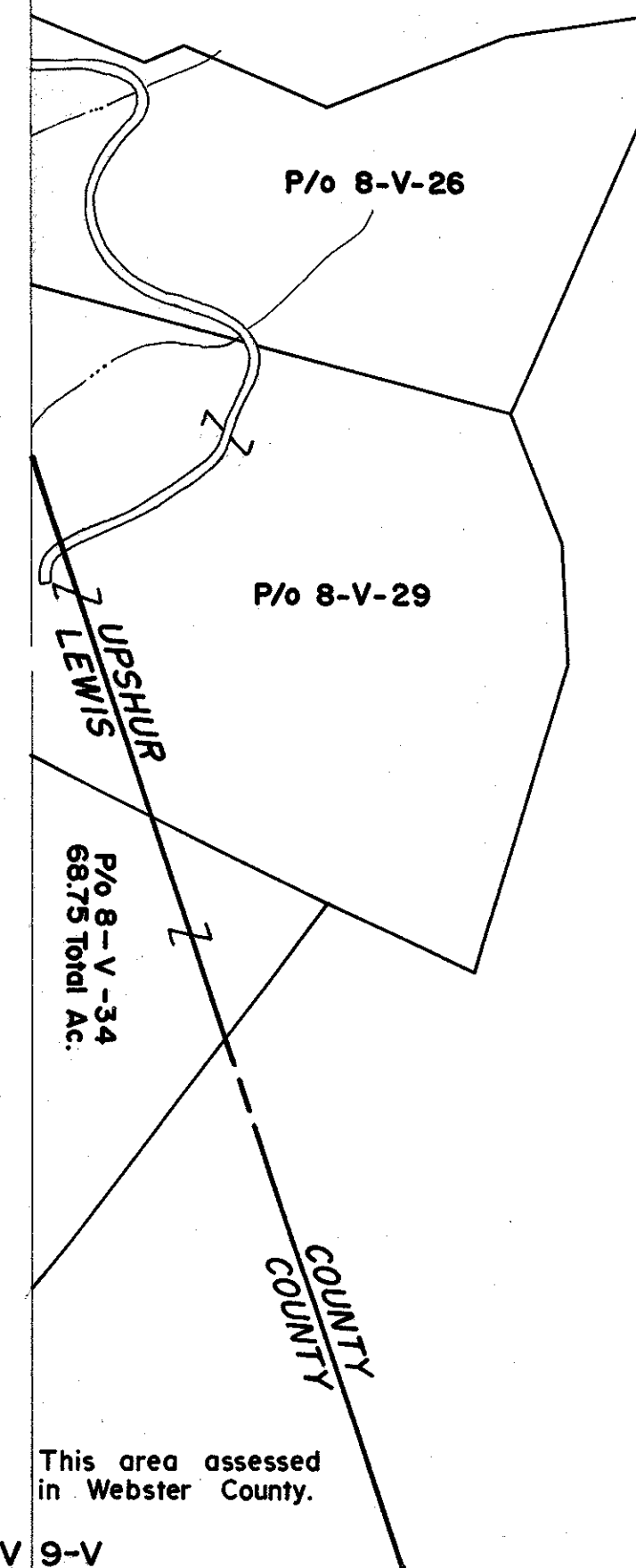

8-V 9-V
8-W 9-W

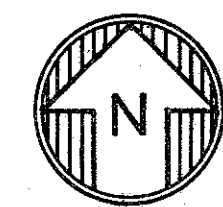

For Tax Purposes Only

Prepared by
VOGT, IVERS AND ASSOCIATES
ENGINEERS-ARCHITECTS
CHARLESTON, W.VA.
CINCINNATI, OHIO

Property line
Edge of pavement or roadway
Corporation line
District line
County line

Original lot line
Deed lot number
Parcel or index number
Improvement
Railroad

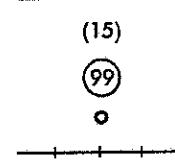

Revisions	
1	Revised to 7-1-81 JDF
2	REV. TO 1-1-90 NCS
3	
4	
5	
6	
7	
8	
9	
10	
11	
12	
13	
14	
15	
16	
17	
18	
19	
20	
21	
22	
23	
24	

KEY MAP

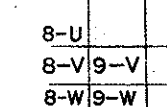

LEWIS COUNTY

STATE OF WEST VIRGINIA

Office of Assessor

DISTRICT

COLLINS SETTLEMENT

SHEET NO: 9-V

Date, Aerial Photography: 4-25-62
Photo No: LE-2-114

Date, Map: 11-3-64
Scale: 1" = 400'