

2-H

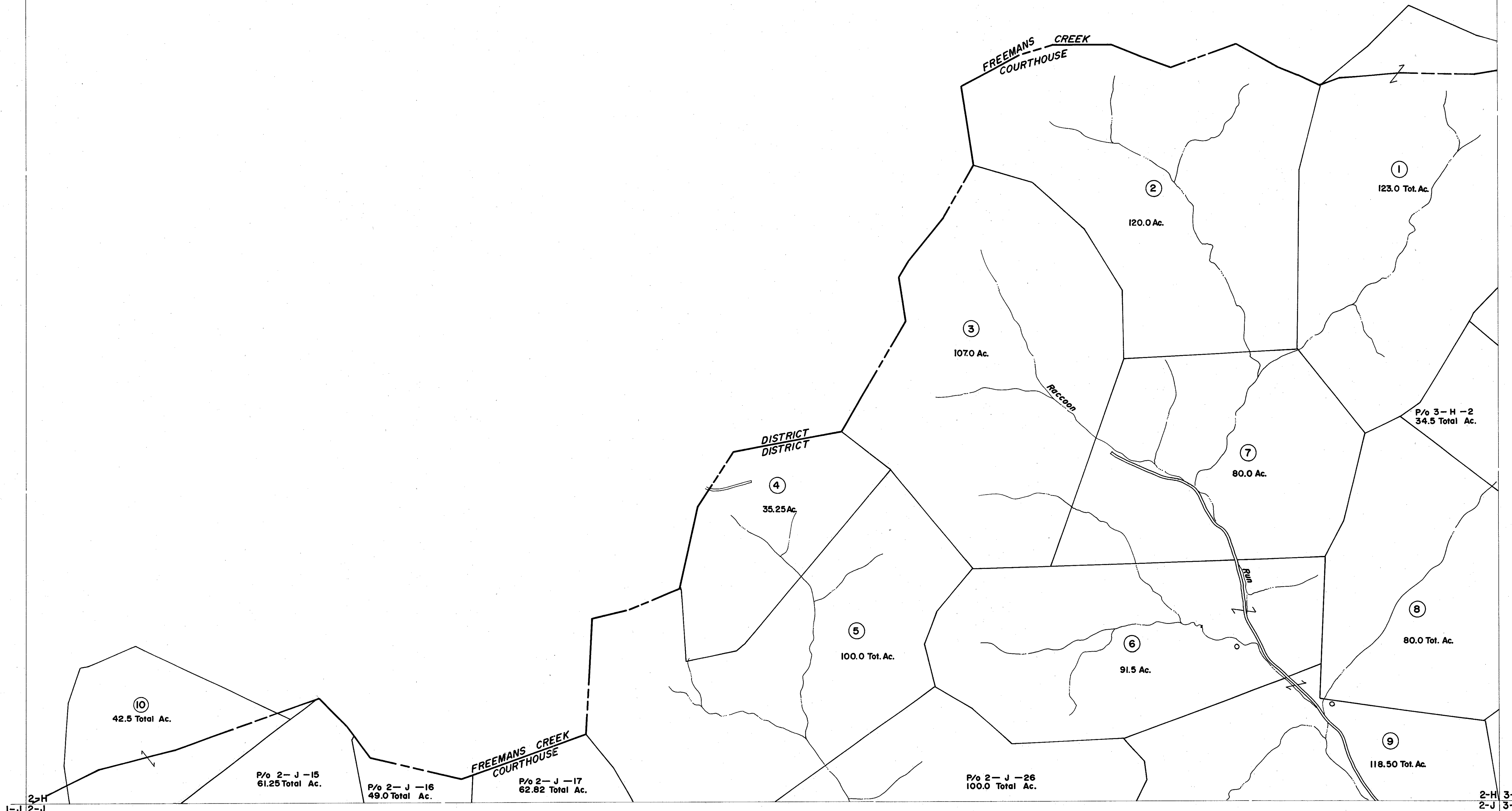

2-H
1-J 2-J

2-H 3-H
2-J 3-J

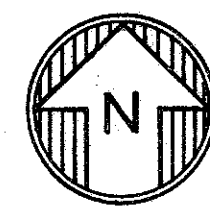

For Tax Purposes Only

Prepared by
VOGT, IVERS AND ASSOCIATES
 ENGINEERS-ARCHITECTS
 CHARLESTON, W.VA.
 CINCINNATI, OHIO

Property line	—————
Edge of pavement or roadway	—————
Corporation line	—————
District line	—————
County line	—————

Original lot line	—————
Deed lot number	(15)
Parcel or Index number	(2)
Improvement	○
Railroad	—+—+—+—

Revisions		
1	Revised to 7/1/61	9
2		10
3		11
4		12
5		13
6		14
7		15
8		16
9		17
10		18
11		19
12		20
13		21
14		22
15		23
16		24

KEY MAP

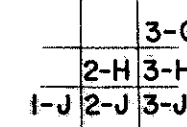

LEWIS COUNTY

STATE OF WEST VIRGINIA

Office of Assessor

DISTRICT
COURTHOUSE

SHEET NO: 2-H

Date, Aerial Photography: 4-25-62
 Photo No: LE-2-13
 Date, Map: 1-4-65
 Scale: 1" = 400'