

WASHINGTON DISTRICT

GILCHRIST ESTATES

GILCHRIST AVE

HUMMING BIRD LN

GILCHRIST AVE

FOR TAX PURPOSES ONLY  
Prepared by Lincoln County, WV

**Legend**  
 Property Line ——— Original Lot Line  
 Road Right of Way ——— Lot Number (15)  
 Corporation Line ——— Parcel Number (99)  
 District Line - - - - - Water  
 County Line ——— Railroad

R	11	Revised 5/12/65	9	17
O	12	Revised 7/1/81	10	18
V	13	Revised 7/1/84	11	19
J	14	Revised 7/1/87	12	20
S	15	Revised 7/1/89	13	21
I	16	Revised 7/1/96	14	22
O	17	Revised 7/1/96	15	23
N	18	Revised 12/30/2016	16	24

**STATE OF WEST VIRGINIA**  
**COUNTY OF LINCOLN**  
 Office of Assessor

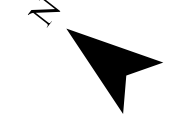
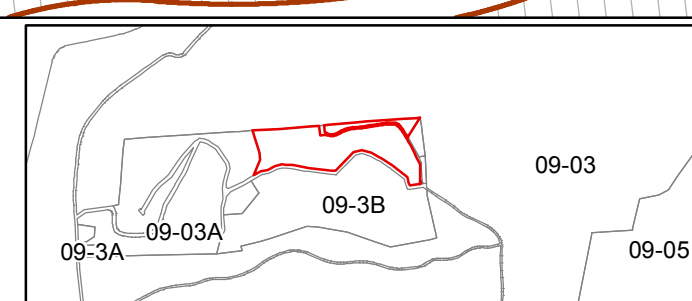

WASHINGTON DISTRICT  
 SHEET 03B  
 Date, Aerial Photography: 2003  
 Created: 2/1/2017  
 Scale: 1" = 100'