

144 145
146 147

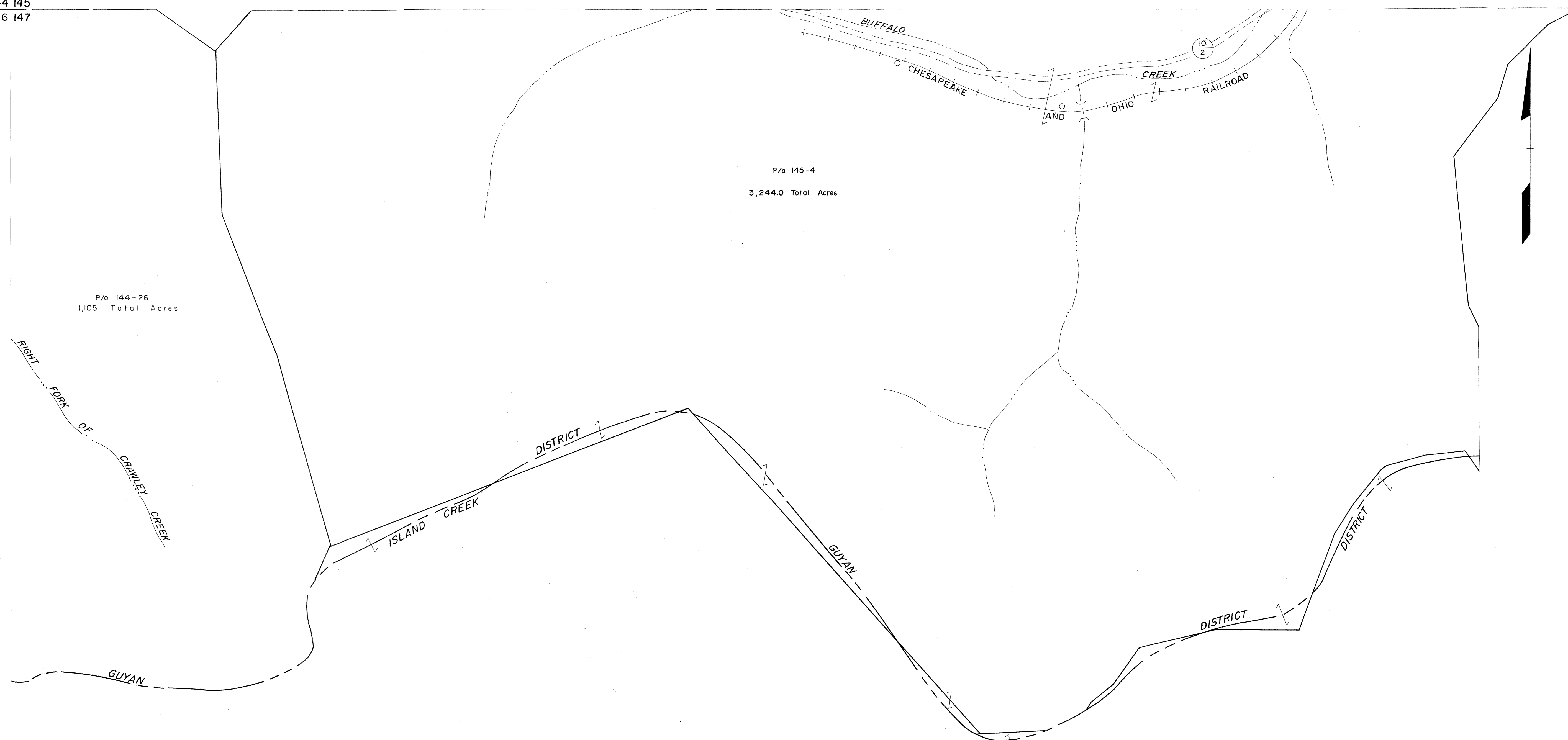

For Tax Purposes Only
Prepared by
MICHAEL BAKER, JR., INC.
Consulting Engineers
Rochester, Pennsylvania

Legend	
Property line	—————
Edge of pavement or roadway	- - - - -
Corporation line	—————
District line	—————
County line	—————
Original lot line	—————
Deed lot number	(15)
Parcel or index number	(22)
Improvement	o
Railroad	—+—+—+—

Revisions			
1	4-1-64	9	17
2	January 1963	10	18
3		11	19
4		12	20
5		13	21
6		14	22
7		15	23
8		16	24

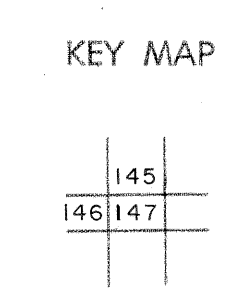

LOGAN COUNTY
STATE OF WEST VIRGINIA
Office of Assessor

DISTRICT	GUYAN
SHEET NO: 147	
Date, Aerial Photography: Nov., 1962	Date, Map: April, 1963
Photo No:	Scale: 1" = 400'