

02-10

02-09

02-13C

02-06

02-05A

02-04

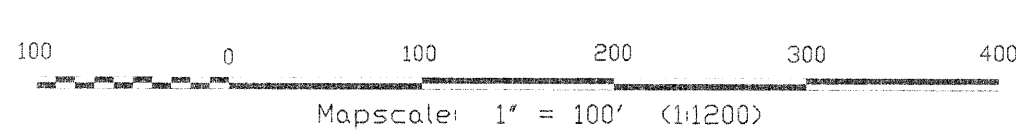
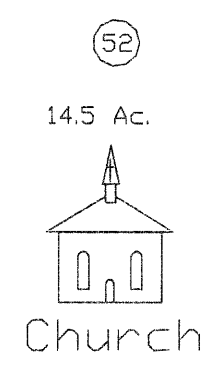

Grant Annex
02-05

All tax maps created under the provisions of reappraisal legislation are the property of the Marion County Reappraisal Program and the reproduction, copying, distribution or sale of such maps or any copies thereof without the written permission of the Marion County Assessor is prohibited by law. 03-14

THIS DOCUMENT IS A TAX MAP: It was compiled for purposes of taxation from available record evidence and has not been field verified. It is not a valid survey plat. The evidence of data on this map does not imply any official status to such data. The WV State Tax Dept. and the Marion County Assessor's Office assume no liability that might result from use of this document.

LEGEND			
Property Line	—————	Original Lot Line	-----
Edge of roadway	- - - - -	Lot number	(#)
Corporation Line	- · - · -	Tax Parcel Number	17
Hydrography	~~~~~	Railroad	+++++

**Office of the
Marion County Assessor**
James P. Priestler, Assessor

Revision	History	Date
1	NEW MAP TN	APRIL 2002
2	NEW MAP JT	2004
3		
4		
5		

Grant Annex
02-05