

**FOR TAX PURPOSES ONLY**  
 THIS MAP IS NOT A LEGAL DOCUMENT  
 NOR IS IT TO BE MISUNDERSTOOD  
 TO BE A LEGAL SURVEY

**Legend**

-----	District Boundary	(15)
-----	Previous Deed	⊙
-----	Property	⊙
-----	Road Easement	⊙
-----	Railroad Right of Way	⊙
-----	Road Right of Way	⊙
-----	River	⊙
-----	Deed lot Number	(15)
-----	Parcel or Index Number	⊙
-----	UNKNOWN	⊙
-----	Improvement	⊙
-----	Cemetery	⊙
-----	School	⊙
-----	Church	⊙

**Restriction**

All tax maps created under the provisions of reappraisal legislation are the property of the Assessor of Mason County, West Virginia and the reproduction, copying, modification, distribution or sale of such tax maps or any copies thereof without the written permission of the Mason County Assessor is prohibited by law.

**Revisions**

1	10	19	28
2	11	20	29
3	12	21	30
4	13	22	31
5	14	23	32
6	15	24	33
7	16	25	34
8	17	26	35
9	18	27	36

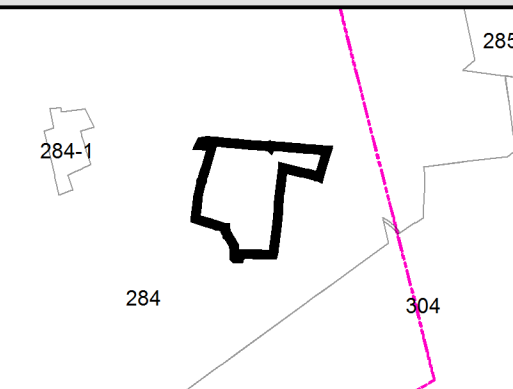

**OFFICE OF THE ASSESSOR**  
**MASON COUNTY**  
**POINT PLEASANT, WV**

**LEWIS**  
**LEWIS 2**  
 Date of Publication: 2/27/2017  
 Scale: 1" = 100'