

**FOR TAX PURPOSES ONLY**  
 THIS MAP IS NOT A LEGAL DOCUMENT  
 NOR IS IT TO BE MISUNDERSTOOD  
 AS TO BE A LEGAL SURVEY

Legend	
	District Boundary
	Previous Deed
	Property
	Road Easement
	Railroad Right of Way
	Road Right of Way
	River
	Deed lot Number (15)
	Parcel or Index Number
	UNKNOWN
	Improvement
	Cemetery
	School
	Church

**Restriction**

All tax maps created under the provisions of reappraisal legislation are the property of the Assessor of Mason County, West Virginia and the reproduction, copying, modification, distribution or sale of such tax maps or any copies thereof without the written permission of the Mason County Assessor is prohibited by law.

Revisions	
1	10
2	11
3	12
4	13
5	14
6	15
7	16
8	17
9	18
	19
	20
	21
	22
	23
	24
	25
	26
	27
	28
	29
	30
	31
	32
	33
	34
	35
	36

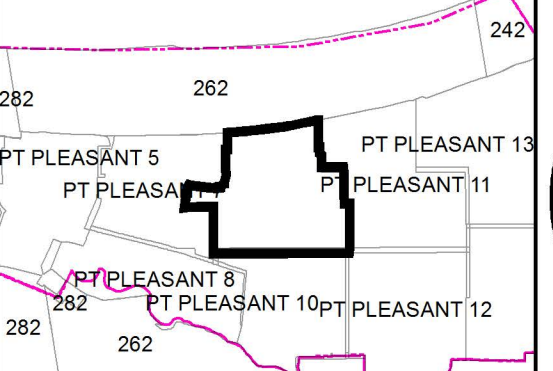

**OFFICE OF THE ASSESSOR**  
**MASON COUNTY**  
 POINT PLEASANT, WV

**POINT PLEASANT**  
**PT PLEASANT 9**  
 Date of Publication: 6/23/2018  
 Scale: 1" = 100'