

FOR TAX PURPOSES ONLY
 THIS MAP IS NOT A LEGAL DOCUMENT
 NOR IS IT TO BE MISUNDERSTOOD
 TO BE A LEGAL SURVEY

Legend	
	District Boundary
	Previous Deed
	Property
	Road Easement
	Railroad Right of Way
	Road Right of Way
	River
	Deed lot Number (16)
	Parcel or Index Number
	UNKNOWN
	Improvement
	Cemetery
	School
	Church

Restriction

All tax maps created under the provisions of reappraisal legislation are the property of the Assessor of Mason County, West Virginia and the reproduction, copying, modification, distribution or sale of such tax maps or any copies thereof without the written permission of the Mason County Assessor is prohibited by law.

Revisions			
1	10	19	28
2	11	20	29
3	12	21	30
4	13	22	31
5	14	23	32
6	15	24	33
7	16	25	34
8	17	26	35
9	18	27	36

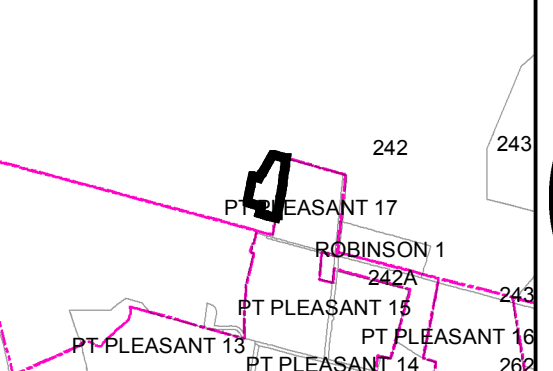

OFFICE OF THE ASSESSOR
MASON COUNTY
 POINT PLEASANT, WV

ROBINSON
242B
 Date of Publication: 1/28/2018
 Scale: 1" = 100'