

FOR TAX PURPOSES ONLY
 THIS MAP IS NOT A LEGAL DOCUMENT
 NOR IS IT TO BE MISUNDERSTOOD
 TO BE A LEGAL SURVEY

Legend	
-----	District Boundary (15)
-----	Previous Deed (16)
-----	Property (17)
-----	Road Easement (18)
-----	Railroad Right of Way (19)
-----	Road Right of Way (20)
-----	River (21)
○	Deed lot Number (22)
○	Parcel or Index Number (23)
○	UNKNOWN (24)
○	Improvement (25)
○	Cemetery (26)
○	School (27)
○	Church (28)

Restriction

All tax maps created under the provisions of reappraisal legislation are the property of the Assessor of Mason County, West Virginia and the reproduction, copying, modification, distribution or sale of such tax maps or any copies thereof without the written permission of the Mason County Assessor is prohibited by law.

Revisions			
1	10	19	28
2	11	20	29
3	12	21	30
4	13	22	31
5	14	23	32
6	15	24	33
7	16	25	34
8	17	26	35
9	18	27	36

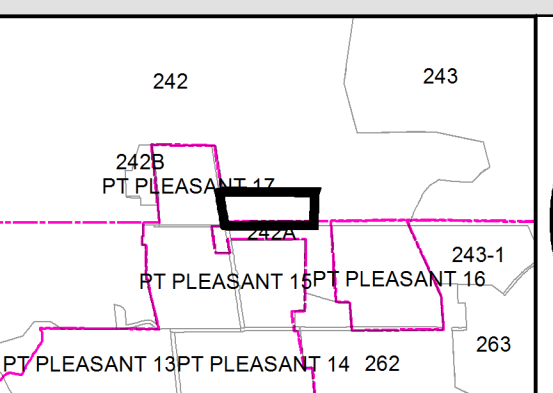

OFFICE OF THE ASSESSOR
MASON COUNTY
POINT PLEASANT, WV

ROBINSON
ROBINSON 1
 Date of Publication: 2/28/2017
 Scale: 1" = 100'