

FOR TAX PURPOSES ONLY
 THIS MAP IS NOT A LEGAL DOCUMENT
 NOR IS IT TO BE MISUNDERSTOOD
 TO BE A LEGAL SURVEY

Legend

-----	District Boundary	(19)
-----	Previous Deed	(9)
-----	Property	UNKNOW
-----	Road Easement	Improvement
-----	Railroad Right of Way	Cemetery
-----	Road Right of Way	School
-----	River	Church

Restriction

All tax maps created under the provisions of reappraisal legislation are the property of the Assessor of Mason County, West Virginia and the reproduction, copying, modification, distribution or sale of such tax maps or any copies thereof without the written permission of the Mason County Assessor is prohibited by law.

Revisions

1	10	19	28
2	11	20	29
3	12	21	30
4	13	22	31
5	14	23	32
6	15	24	33
7	16	25	34
8	17	26	35
9	18	27	36

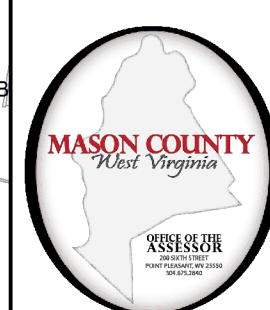
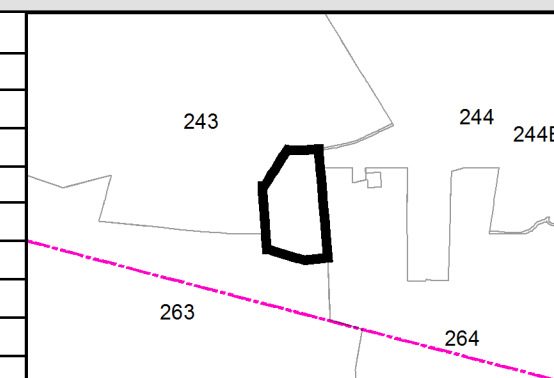

OFFICE OF THE ASSESSOR
MASON COUNTY
 POINT PLEASANT, WV

ROBINSON

243A

Date of Publication: 2/26/2017

Scale: 1" = 100'