

232 233
252 253

233 234
253 254

252 253
272 273

253 254
273 274

UPPER BELCHER BRANCH

BROWNS CREEK ADKIN

HARMAN BRANCH

NORFOLK & WESTERN RAILROAD

ELKHORN CREEK

②
1,924.39 AC.

③
C-276 TOTAL ACRES
D-355.69 " "

P/6 234-12

P/6 254-4

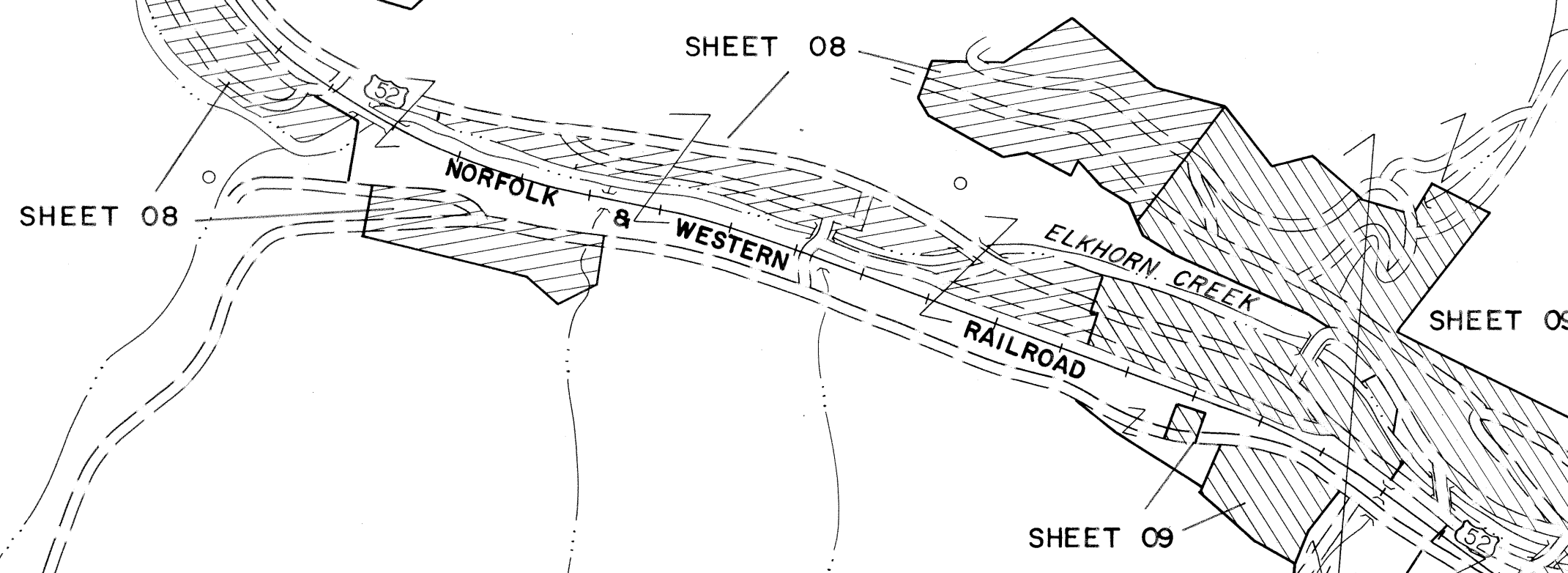

For Tax Purposes Only
 Prepared by
MICHAEL BAKER, JR., INC.
 Consulting Engineers
 Rochester, Pennsylvania

Legend	
Property line	Original lot line
Edge of pavement or roadway	Deed lot number
Corporation line	Parcel or index number
District line	Improvement
County line	Railroad

Revisions	
1	4-15-64
2	12-10-74 T.G.
3	Revised to 7-1-83 J.E.B.
4	7/1/84 R.L.B.
5	July 1985 J.E.B.
6	6.6.1.S 5-15-95 J.E.B.
7	SLS INC. 12/30/98 DSW
8	

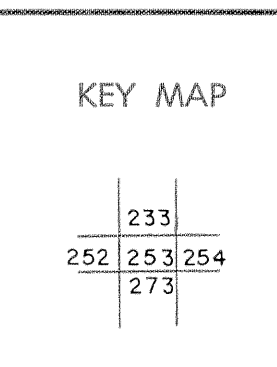

MCDOWELL COUNTY
 STATE OF WEST VIRGINIA
 Office of Assessor

DISTRICT **BROWNS CREEK ADKIN**
SHEET NO: 253
 Date, Aerial Photography: April, 1961 Date, Map: July, 1962
 Photo No: Scale: 1" = 400'