

103 104  
123 124

104  
124

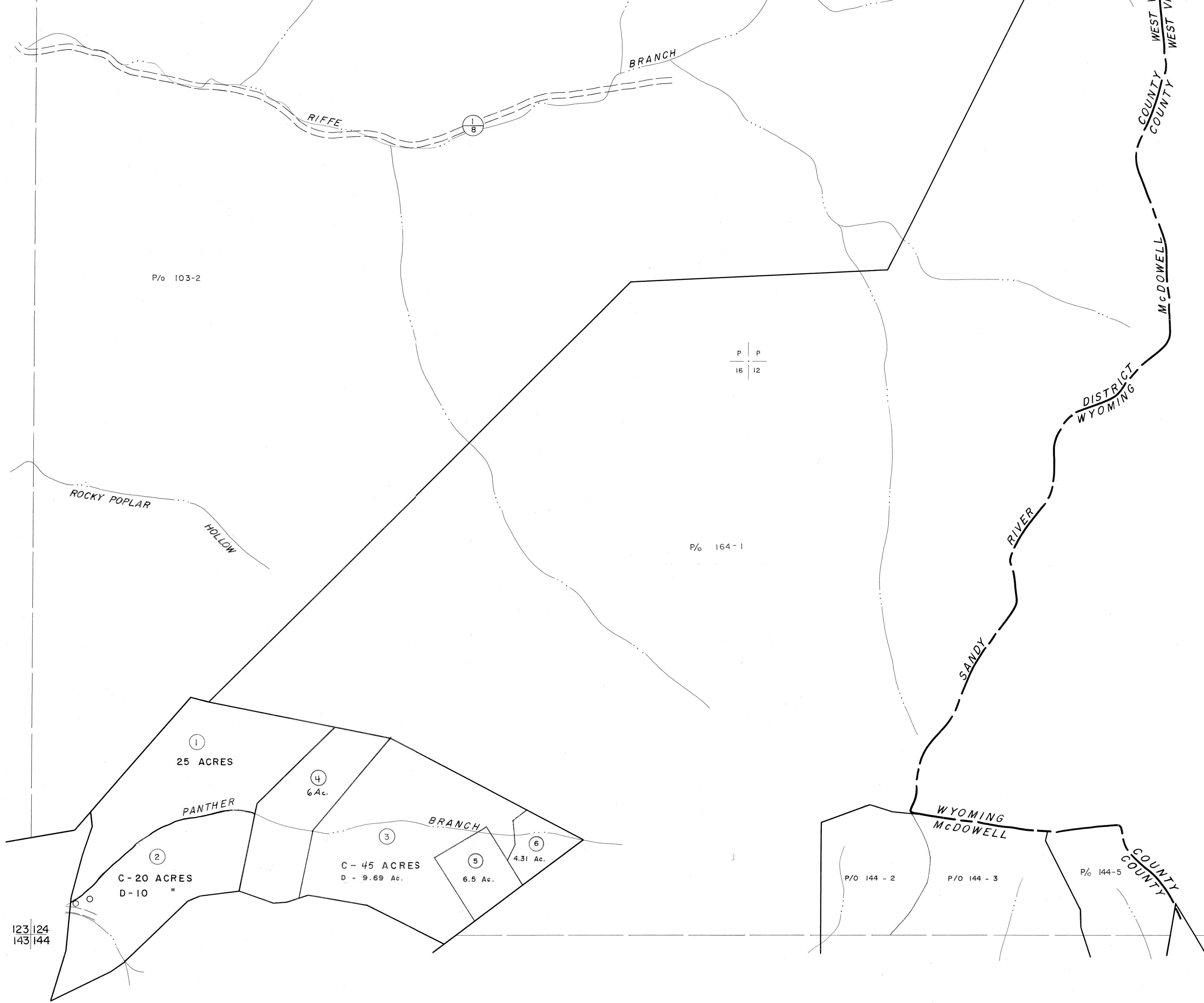

123 124  
143 144

124  
144 145

For Tax Purposes Only

Prepared by  
**MICHAEL BAKER, JR., INC.**  
 Consulting Engineers  
 Rochester, Pennsylvania

Legend	
Property line	—————
Edge of pavement or roadway	——— ———
Corporation line	—————
District line	—————
County line	—————
Original lot line	-----
Deed lot number	(15)
Parcel or index number	(9)
Improvement	o
Railroad	—+—

Revisions			
1	4-15-64	9	17
2	12-3-74	10	18
3	Revised 7-1-83 J.E.B.	11	19
4	July 1985 J.E.B.	12	20
5	O.G.I.S. 5-15-95 J.E.B.	13	21
6	5/24/04 S&H	14	22
7		15	23
8		16	24

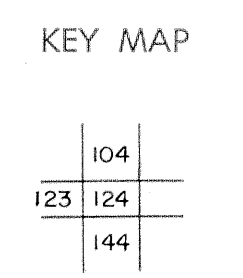

**McDOWELL COUNTY**  
 STATE OF WEST VIRGINIA  
 Office of Assessor

DISTRICT  
**SANDY RIVER**

SHEET NO: 124

Date, Aerial Photography: April, 1961 Date, Map: July, 1962  
 Photo No: Scale: 1" = 400'