

281 282
302 303

282 283
302 303

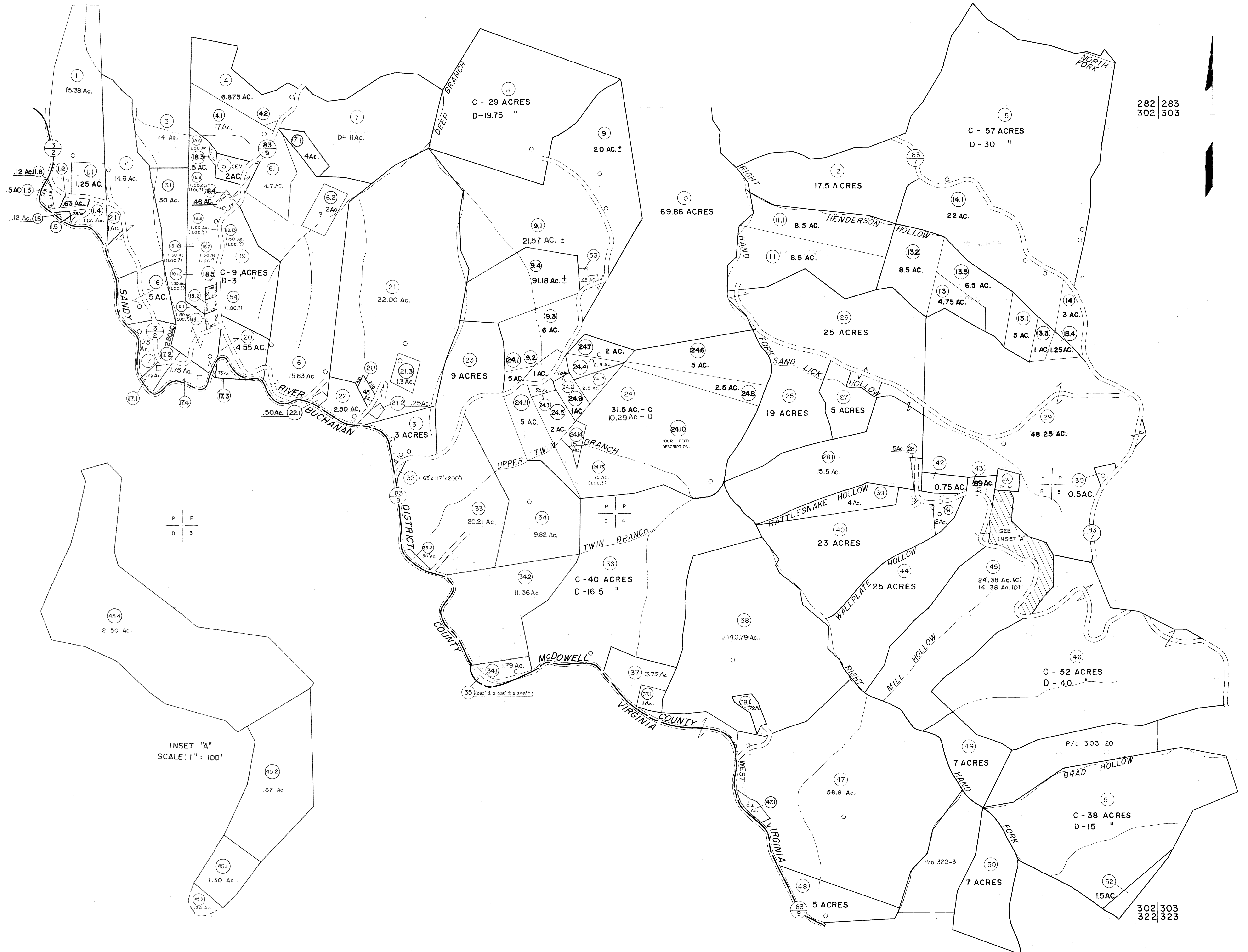

P P
8 3

INSET "A"
SCALE: 1" = 100'

For Tax Purposes Only

Prepared by
MICHAEL BAKER, JR., INC.
Consulting Engineers
Rochester, Pennsylvania

Legend

Property line	—	Original lot line	- - - - -
Edge of pavement or roadway	—+—+—	Deed lot number	(05)
Corporation line	—+—+—	Parcel or index number	(99)
District line	—+—+—	Improvement	o
County line	—+—+—	Railroad	—+—+—

Revisions

1	4-15-64	9	O.G.I.S	12-1-96	J.E.B	17
2	12-3-74	10	SLS INC.	6/26/98	J.W.M	18
3	Revised to 7-1-83	11	SLS INC.	1/4/99	D.S.W	19
4	7-1-84	12	ESI	4/27/01	REK	20
5	Revised to 7-1-88	13	ESI	12/5/02	REK	21
6	Revised to 7-1-88	14	5/23/04	S.B.H		22
7	Revised to 7-1-89	15	5-15-05	H.F.S		23
8	O.G.I.S	16	5-15-95	J.E.B		24
				8/27/06		

KEY MAP

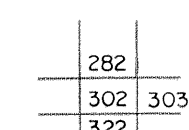

McDOWELL COUNTY
STATE OF WEST VIRGINIA
Office of Assessor

DISTRICT
SANDY RIVER

SHEET NO: 302

Date, Aerial Photography: April, 1961
Photo No: Date, Map: July, 1962
Scale: 1" = 400'

302 322

302 303
322 323