



**For Tax Purposes Only**

Prepared by  
**MICHAEL BAKER, JR., INC.**  
 Consulting Engineers  
 Rochester, Pennsylvania

**Legend**

Property line	—	Original lot line	---
Edge of pavement or roadway	—	Deed lot number	(15)
Corporation line	---	Parcel or index number	(22)
District line	---	Improvement	o
County line	---	Railroad	—

**Revisions**

No.	Date	By	For
1	4-15-64	S&H	12/31/05
2	12-10-74	B.H.	
3	Revised to 7-1-83	J.P.	
4	7-1-83	J.P.	
5	06.15 5-15-95	J.E.B.	
6	5/23/04	S&H	
7	5-15-05	H.H.S.	
8			

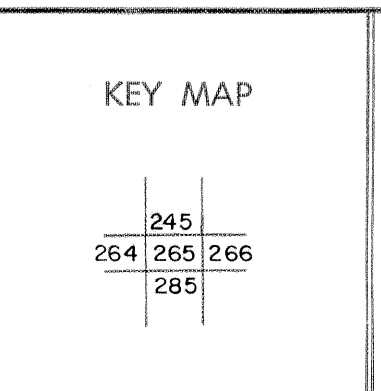

**McDOWELL COUNTY**  
 STATE OF WEST VIRGINIA  
 Office of Assessor

DISTRICT  
**SANDY RIVER**

**SHEET NO: 265**

Date, Aerial Photography: April, 1961 Date, Map: July, 1962  
 Photo No: Scale: 1" = 400'