

222 | 223
242 | 243

223 | 224
243 | 244

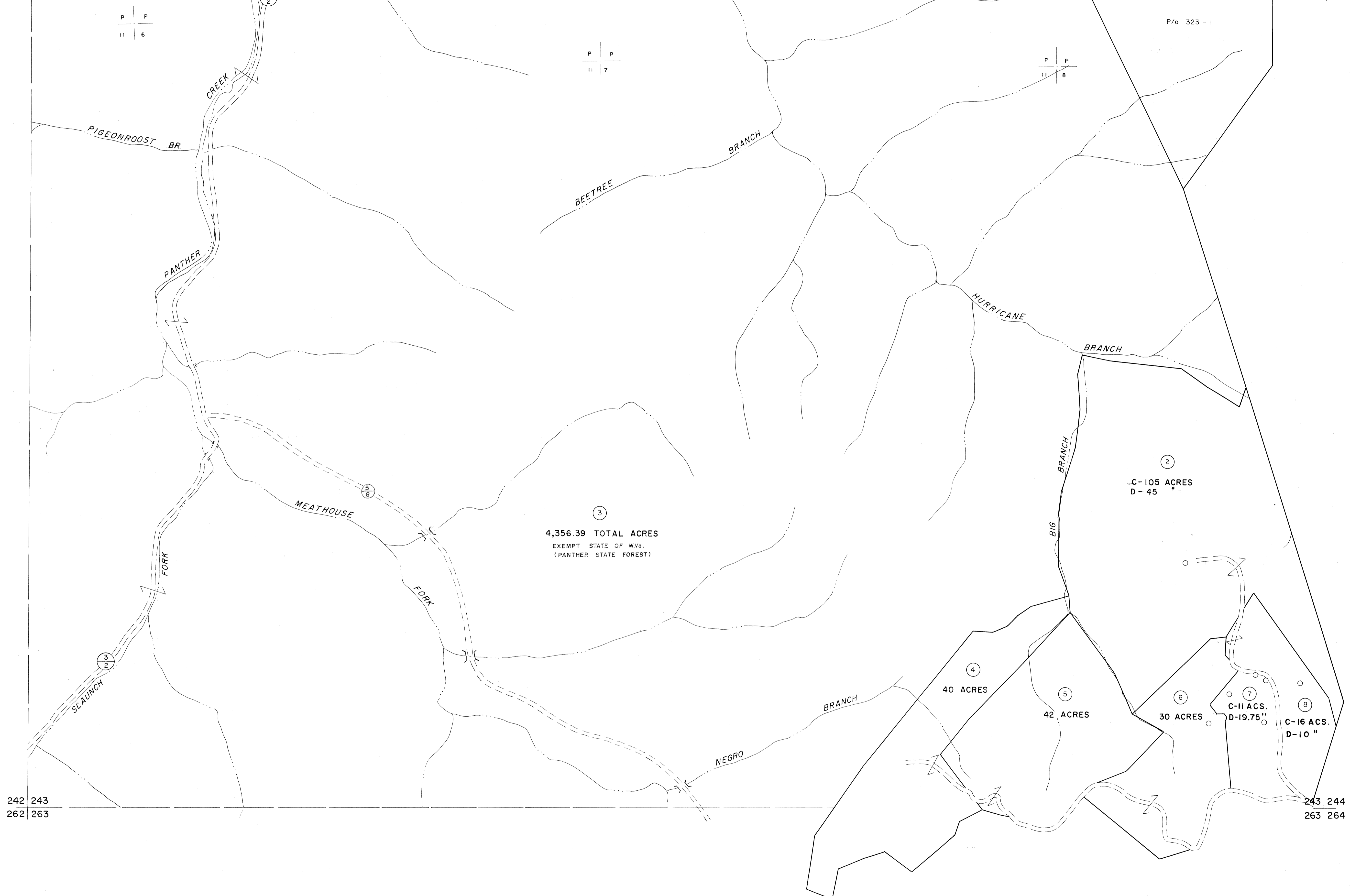

For Tax Purposes Only

Prepared by
MICHAEL BAKER, JR., INC.
Consulting Engineers
Rochester, Pennsylvania

Legend

| | | | |
|-----------------------------|-------|------------------------|-------|
| Property line | ——— | Original lot line | ----- |
| Edge of pavement or roadway | ——— | Deed lot number | (15) |
| Corporation line | ----- | Parcel or index number | (22) |
| District line | ----- | Improvement | o |
| County line | ----- | Railroad | + |

Revisions

| | | | |
|---|-------------------------|----|----|
| 1 | 4-15-64 | 9 | 17 |
| 2 | Revised 6-7-1963 J.E.B. | 10 | 18 |
| 3 | O.G.I.S 5-15-95 J.E.B | 11 | 19 |
| 4 | ESI 12/4/02 REK | 12 | 20 |
| 5 | | 13 | 21 |
| 6 | | 14 | 22 |
| 7 | | 15 | 23 |
| 8 | | 16 | 24 |

KEY MAP

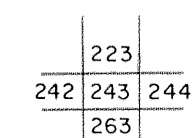

McDOWELL COUNTY
STATE OF WEST VIRGINIA
Office of Assessor

DISTRICT

SANDY RIVER

SHEET NO: 243

Date, Aerial Photography: April, 1961 Date, Map: July, 1962
Photo No: Scale: 1" = 400'