

281 | 282
302 | 303

282 | 283
302 | 303

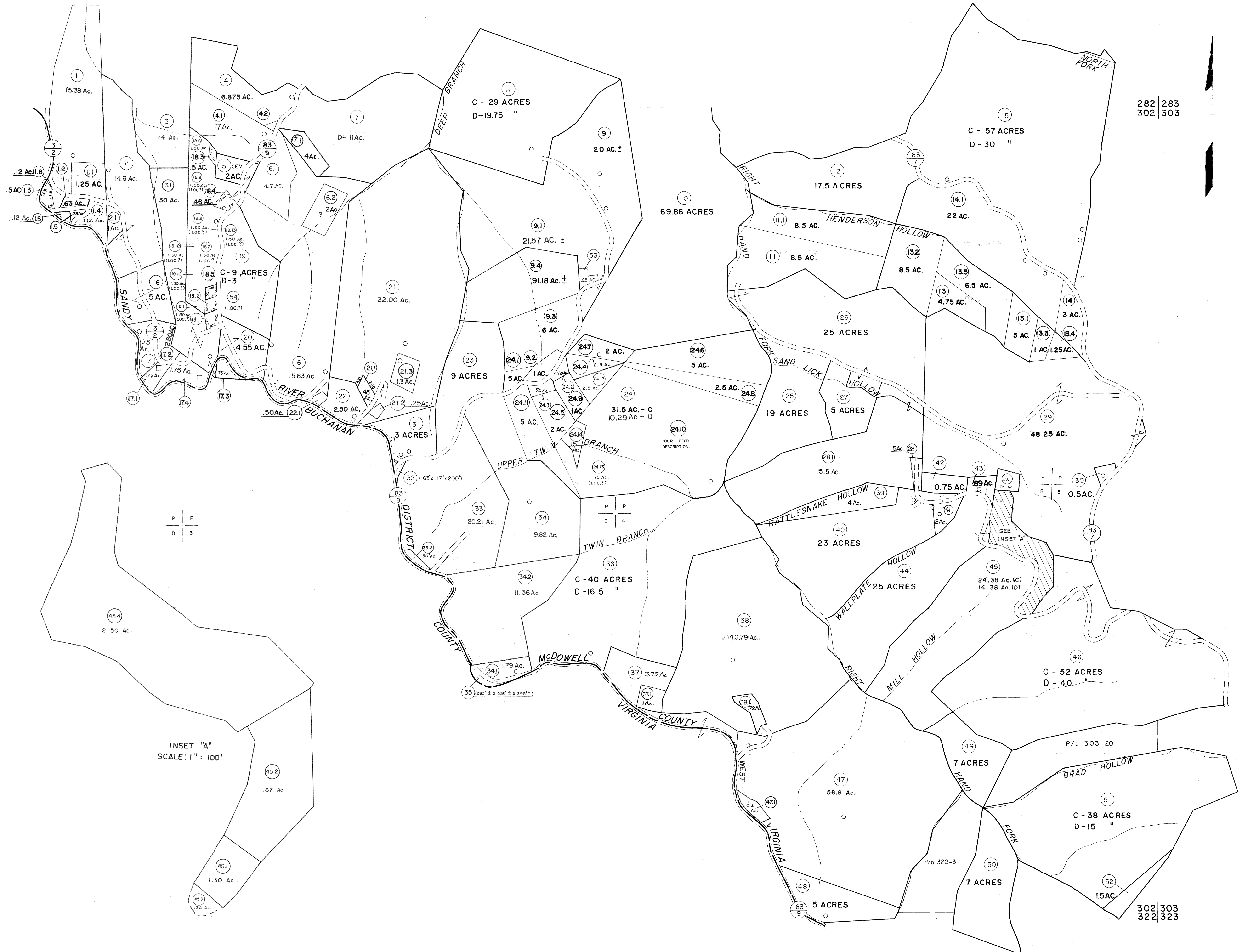

P P
8 3

INSET "A"
SCALE: 1" = 100'

For Tax Purposes Only

Prepared by
MICHAEL BAKER, JR., INC.
Consulting Engineers
Rochester, Pennsylvania

Legend	
Property line	Original lot line
Edge of pavement or roadway	Deed lot number
Corporation line	Parcel or index number
District line	Improvement
County line	Railroad

Revisions			
1	4-15-64	9	O.G.I.S 12-1-96 J.E.B 17
2	12-3-74 DAE	10	SLS INC. 6/26/98 JWM 18
3	Revised to 7-1-83 J.E.B	11	SLS INC. 1/4/99 DSW 19
4	7-1-84 L.E.S.	12	ESI 4/27/01 REK 20
5	Revised to 7-1-88 J.E.B	13	ESI 12/5/02 REK 21
6	Revised to 7-1-89 J.E.B	14	5/23/04 S.B.H 22
7	Revised to 7-1-89 J.E.B	15	5-15-05 H.F.S 23
8	O.G.I.S 5-15-95 J.E.B	16	S.B.H 8/27/06 24

KEY MAP

282
302 303
322

McDOWELL COUNTY
STATE OF WEST VIRGINIA
Office of Assessor

DISTRICT
SANDY RIVER

SHEET NO: 302

Date, Aerial Photography: April, 1961
Photo No: _____
Date, Map: July, 1962
Scale: 1" = 400'

302 | 303
322 | 323