

202 | 203
222 | 223

203 | 204
223 | 224

222 | 223
242 | 243

223 | 224
243 | 244

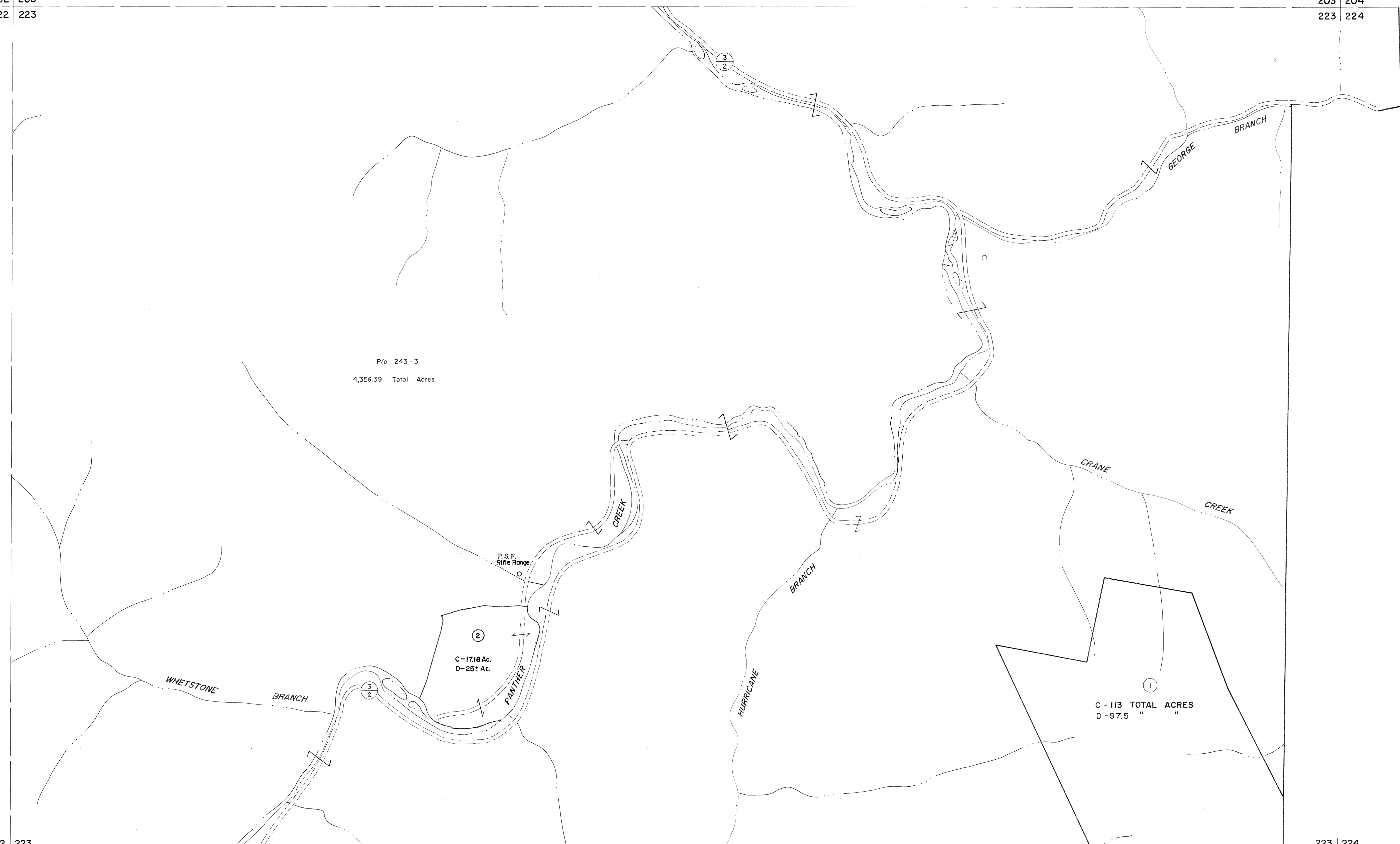

P/O 243-3
4,356.39 Total Acres

②
C-17.18 Ac.
D-25.4 Ac.

①
C-113 TOTAL ACRES
D-97.5 "

For Tax Purposes Only

Prepared by
MICHAEL BAKER, JR., INC.
Consulting Engineers
Rochester, Pennsylvania

Legend

Property line	—————	Original lot line	-----
Edge of pavement or roadway	-----	Dead lot number	(15)
Corporation line	-----	Parcel or index number	(22)
District line	-----	Improvement	○
County line	-----	Railroad	—+—+—+—

Revisions

1	4-15-64	9	17
2	Revised to 7-1-63	10	18
3	July 1965	11	19
4	6-18-07	12	20
5		13	21
6		14	22
7		15	23
8		16	24

KEY MAP

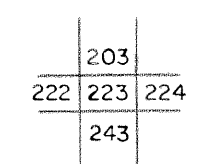

McDOWELL COUNTY
STATE OF WEST VIRGINIA
Office of Assessor

DISTRICT
SANDY RIVER

SHEET NO: 223

Date, Aerial Photography: April, 1961
Photo No: _____
Date, Map: July, 1962
Scale: 1" = 400'