

281 | 282
302 | 303

282 | 283
302 | 303

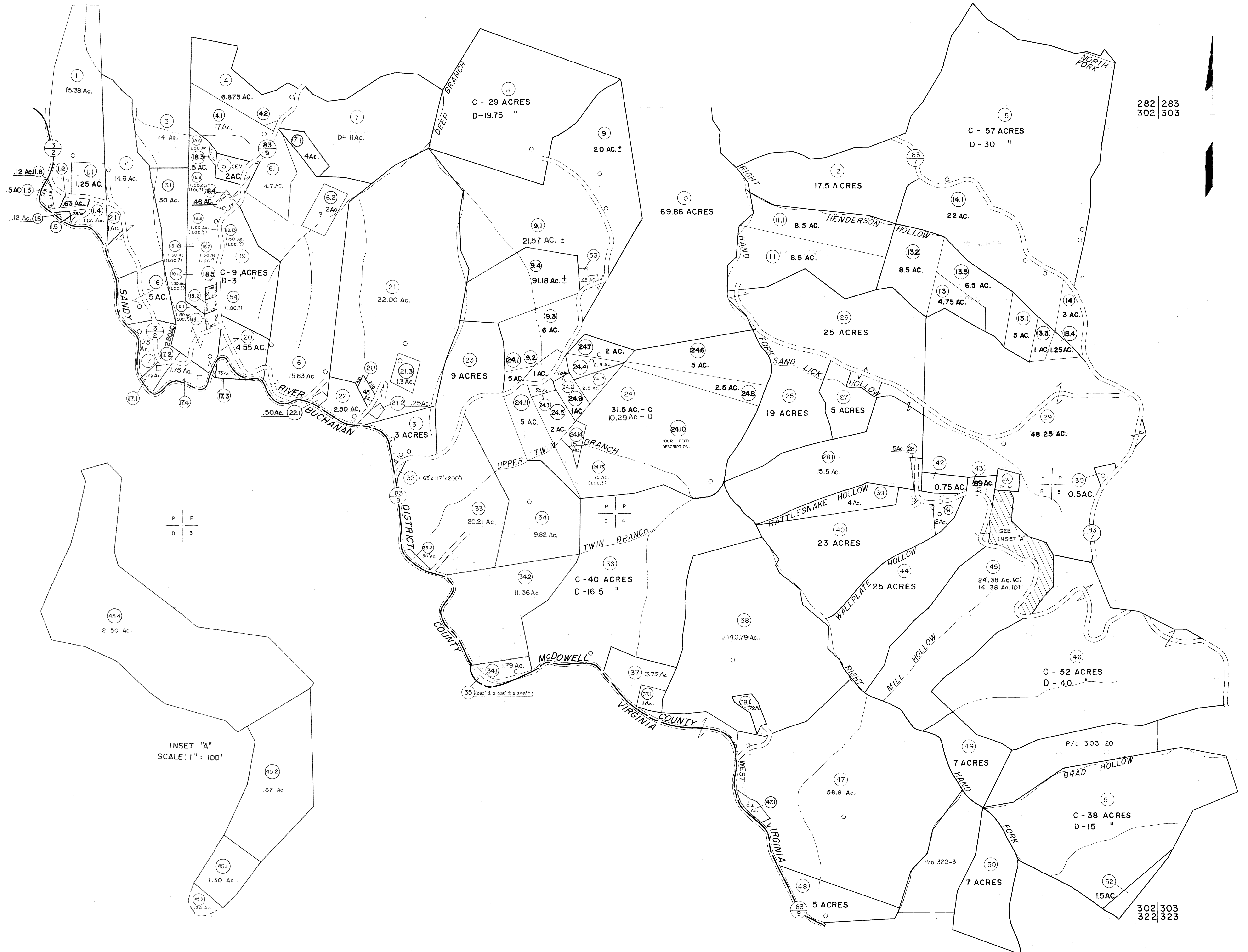

P P
B 3

INSET "A"
SCALE: 1" = 100'

For Tax Purposes Only

Prepared by
MICHAEL BAKER, JR., INC.
Consulting Engineers
Rochester, Pennsylvania

Legend

Property line	-----	Original lot line	-----
Edge of pavement or roadway	-----	Deed lot number	(05)
Corporation line	-----	Parcel or index number	(99)
District line	-----	Improvement	o
County line	-----	Railroad	+

Revisions

1	4-15-64	9	O.G.I.S	12-1-96	J.E.B	17
2	12-3-74	10	SLS INC.	6/26/98	JWM	18
3	Revised to 7-1-83	11	SLS INC.	1/4/99	DSW	19
4	7-1-84	12	ESI	4/27/01	REK	20
5	Revised to 7-1-88	13	ESI	12/5/02	REK	21
6	Revised to 7-1-88	14	5/23/04	S.B.H		22
7	Revised to 7-1-89	15	5-15-05	H.F.S		23
8	O.G.I.S	16	5-15-95	J.E.B		24
				8/27/06		

KEY MAP

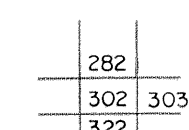

McDOWELL COUNTY

STATE OF WEST VIRGINIA

Office of Assessor

DISTRICT

SANDY RIVER

SHEET NO: 302

Date, Aerial Photography: April, 1961
Photo No:

Date, Map: July, 1962
Scale: 1" = 400'

302 | 322

302 | 303
322 | 323