

455 456  
475 476

456  
476

475 476  
495 496

476  
496

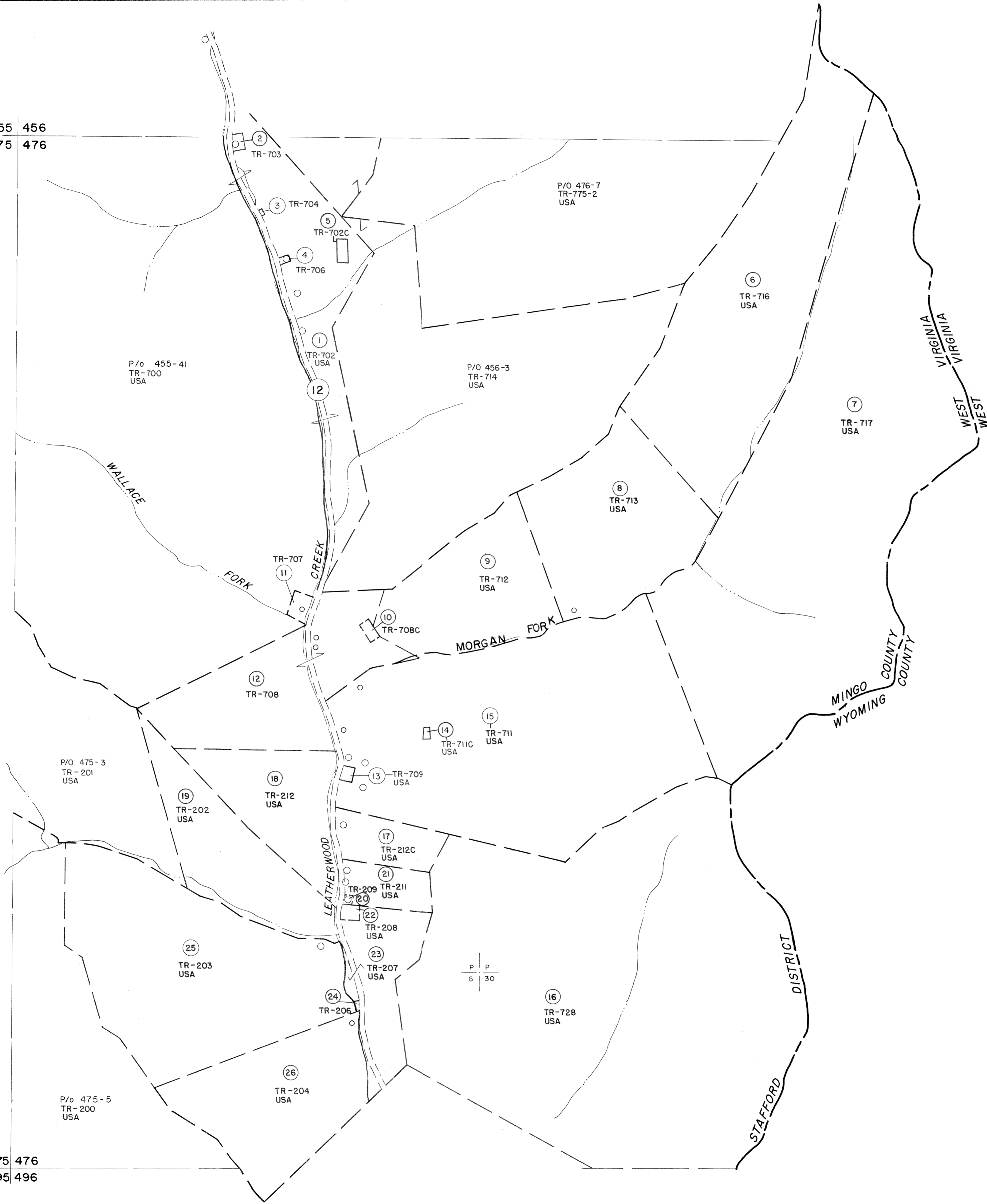

**For Tax Purposes Only**

Prepared by  
**MICHAEL BAKER, JR., INC.**  
Consulting Engineers  
Rochester, Pennsylvania

**Legend**

Property line	—————	Original lot line	-----
Edge of pavement or roadway	—————	Deed lot number	(15)
Corporation line	-----	Parcel or index number	(29)
District line	-----	Improvement	O
County line	-----	Railroad	—+—

**Revisions**

1	9-18-63	9	17
2	10-1-63	10	18
3	9-25-74	11	19
4	3-31-84	12	20
5	7-1-84	13	21
6	12-17-86	14	22
7		15	23
8		16	24

**KEY MAP**

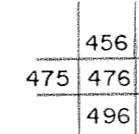

**MINGO COUNTY**  
STATE OF WEST VIRGINIA  
Office of Assessor

DISTRICT

**STAFFORD**

**SHEET NO: 476**

Date, Aerial Photography: April, 1961 Date, Map: July, 1962  
Photo No: Scale: 1" = 400'