





**FOR TAX
PURPOSES ONLY**

Prepared By:
Ronald McIntire
San County Assessor

Legend

Deed lot Number	(15)
Parcel or Index Number	9
Unknown	
Improvement	<input type="radio"/>
Cemetery	
Church	
Educational	

Restriction

REPRODUCTION OF TAX MAPS PROHIBITED
 It is unlawful to copy, photocopy, scan, photograph, or otherwise reproduce this tax map. Pursuant to the provisions of W.Va. CSR § 189-5-13 (2013) no person may reproduce, copy, distribute or sell copies of tax maps prepared by the counties without having first obtained the written permission of the Morgan County Assessor. In addition to other penalties and civil remedies, any person who, without the written permission of the Morgan County Assessor, reproduces, copies, distributes, or sells or who allows the reproduction or copying or distribution of tax maps prepared by the Morgan County Assessor, shall be refused permission by the Morgan County Assessor or Assessor's agent to purchase tax maps in the future.

Revisions

1	Revised 12/30/2016	10	19
2		11	20
3		12	21
4		13	22
5		14	23
6		15	24
7		16	25
8		17	26
9		18	27

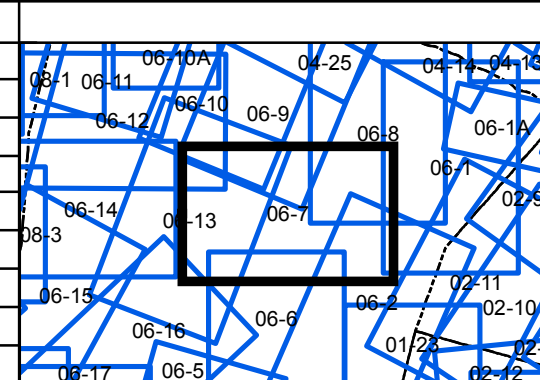

MORGAN COUNTY

Assessor's Office
Ronald McIntire, Assessor
Berkeley Springs, WV

ROCK GAP

District: 06 Map No: 7
Date of Publication: 1/25/2017
Scale: 1" = 200'