

For Tax Purposes Only
 Prepared By:
ERNIE DENNISON
NICHOLAS COUNTY ASSESSOR

Legend	
Water	<all other values>
Sub_Type	<all other values>
Swamp	Boundary
Water	Corp_Boundary
Roads	Map
RailRoad	Map_Boundary
Road_Dashed	TaxParcels
Roads	PRINT-GRID#2

West Virginia Legislative Regulations
 Property Valuation Training and Procedures Commission
 Title 189 Series 5 Article 5 Section 5.1
 Reproduction of tax maps prohibited
 No person may reproduce, copy, distribute
 or sell copies of tax maps prepared by the
 counties without having first obtained the
 written permission of the County Assessor.

NICHOLAS COUNTY
 WEST VIRGINIA
 Office Of Assessor

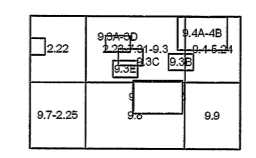

Wilderness
8A-8B-8C
 1 inch = 200 feet
 Revised: Apr 25, 2012