

0

10

0

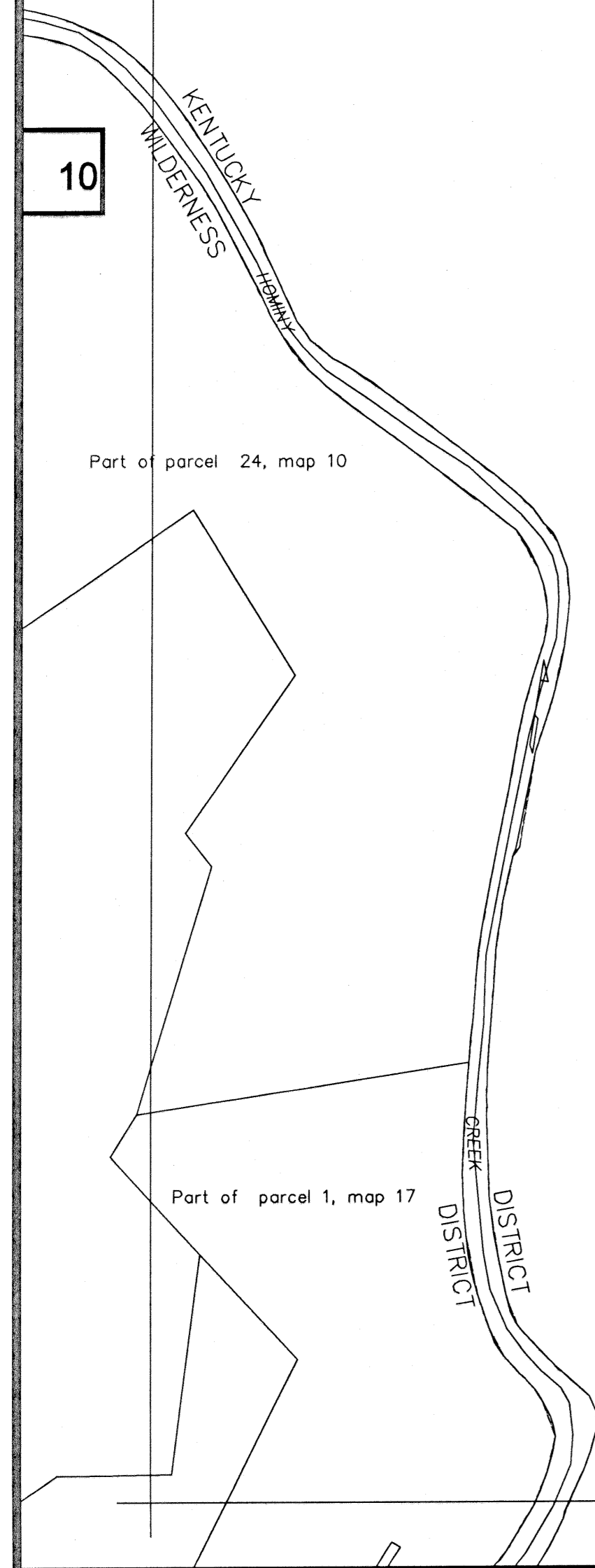

SEE 33

17

FOR TAX PURPOSE ONLY

PREPARED BY
ERNIE DENNISON
NICHOLAS COUNTY ASSESSOR



Legend

Property line	—————	Original lot line	—————
Edge of pavement or roadway	=====	Deed lot number & pavement	(15)
Corporation line	=====	Parcel or index number	99
District line	=====	Improvement	•
County line	=====	Railroad	—+—+—+—

Revisions

1	5-2-2003	TER	9
2	1-24-2005	TER	10
3			11
4			12
5			13
6			14
7			15

NICHOLAS COUNTY - WEST VIRGINIA
Office of Assessor

WILDERNESS DISTRICT

City - Town - District:

Map No: **11**

Date, Aerial Photography: 4-20-61 Date, Map: 7-19-62

Photo No: Scale: 1"=400'