

FOR TAX PURPOSES ONLY

Prepared By:
Kathie Hoffman
 Ohio County Assessor

Legend	
Property Line	—
Edge of pavement or roadway	- - - - -
Corporation line	- · - · -
District line	- - - - -
County Line	==
Original Lot Line	— (dashed)
Deed lot number (in parenthesis)	(15)
Parcel or index number	MAP-15
Improvement	○
Railroad	- + - + -

Restriction	
W12C	W14H
R14E	R14G
W14C	W14D
	R14H
	R14I
	W17D
	R14M
	R14R

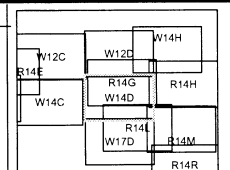

All tax maps created under the provisions of reappraisal legislation are the property of the Assessor of Ohio County, West Virginia and the reproduction, copying, modification, distribution or sale of such tax maps or any copies thereof without the written permission of the Ohio County Assessor is prohibited by law.

OHIO COUNTY - WEST VIRGINIA
 Office of Assessor

Map No: W14D
 Drawn By: David Weaver
 Date: Jun 01, 2009
 Scale: 1 inch = 100 feet