

FOR TAX PURPOSES ONLY

Prepared By:
Kathie Hoffman
 Ohio County Assessor

Legend	
Property Line	—————
Edge of pavement or roadway	- - - - -
Corporation line	· · · · ·
District line	· · · · ·
County Line	· · · · ·
Original Lot Line	————— (15)
Deed lot number (in parenthesis)	(15)
Parcel or index number	MAP-15
Improvement	○
Railroad	—————

Restriction	
W25	W26
W27	W27A
W33	W34
T2J	

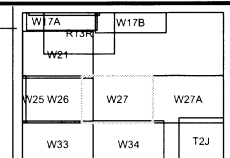

OHIO COUNTY - WEST VIRGINIA
 Office of Assessor

Map No: W27
 Drawn By: David Weaver
 Date: Jun 03, 2009
 Scale: 1 inch = 100 feet